

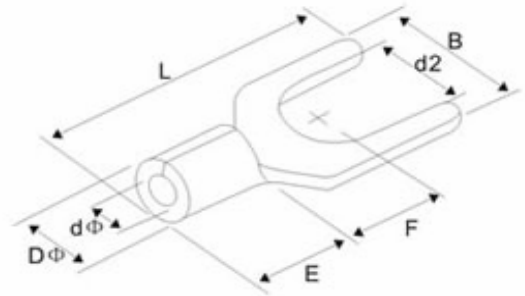

**Technical Specification**

Maximum Electrical Ratings:	75°C / 600V
Maximum Electrical Ratings:	22-16AWG/ 0,5-1,5mm <sup>2</sup> 19A
	16-14AWG/ 1,5-2,5mm <sup>2</sup> 27A
	14-12AWG/ 2,5-4,0mm <sup>2</sup> 37A
	12-10AWG/4-6mm <sup>2</sup> 48A
Terminal Body:	Copper
Insulation:	Non Isolation
Plating:	Tin

**Technical Drawing**



**This Dimensions are for I-max. 115A**

Order Code	Stud Size	d2	B	L	F	E	DØ	dØ							Color
A0	1/4	6,5	14,0	34,5	9,5	12,0	11,5	7,7							without plastic
A1	5/16	8,5	14,0	34,5	13,5										
A2															
A3															
A4															
A5															
A6															
A7															
A8															
A9															
B0															
B1															
B2															
B3															

**Ordering Information**

Serie	Order Code	ROHS	Packing			
-------	------------	------	---------	--	--	--

<b>N38012</b>	<b>A0</b>	<b>R</b>	<b>BU102</b>			
---------------	-----------	----------	--------------	--	--	--

look table	R= ROHS conform	<b>BU102</b> 1000PCs in one poly bag
	N= Non ROHS conform	

<b>Fork Bare end NON-Insulated</b>	
Part No.:	<b>N38012</b>
Customer:	

DRW:	Jason	CHKD	Jules	MATL:	Wu	DATE	15.03.2010
APPD:	Join			FINISH	Shieh	Sheet	1 from 1