

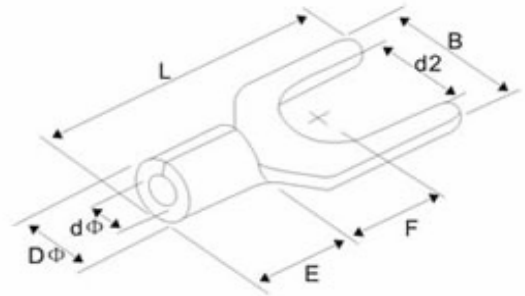

Technical Specification

Maximum Electrical Ratings:	75°C / 600V
Maximum Electrical Ratings:	22-16AWG/ 0,5-1,5mm ² 19A
	16-14AWG/ 1,5-2,5mm ² 27A
	14-12AWG/ 2,5-4,0mm ² 37A
	12-10AWG/4-6mm ² 48A
Terminal Body:	Copper
Insulation:	Non Isolation
Plating:	Tin

Technical Drawing



This Dimensions are for I-max. 62A

Order Code	Stud Size	d2	B	L	F	E	DØ	dØ							Color
A0	#8	4,3	8,0	23,0	7,2	8,5	7,2	4,5							without plastic
A1	#10	5,3	10,8	23,0	7,2										
A2	1/4	6,5	10,8	23,0	7,2										
A3	5/16	8,5	14,5	28,0	10,7										
A4															
A5															
A6															
A7															
A8															
A9															
B0															
B1															
B2															
B3															

Ordering Information

Serie	Order Code	ROHS	Packing			
-------	------------	------	---------	--	--	--

N38010	A0	R	BU102			
---------------	-----------	----------	--------------	--	--	--

look table	R= ROHS conform	BU102 1000PCs in one poly bag
	N= Non ROHS conform	

Fork Bare end NON-Insulated	
Part No.:	N38010
Customer:	

DRW:	Jason	CHKD	Jules	MATL:	Wu	DATE	15.03.2010
APPD:	Join			FINISH	Shieh	Sheet	1 from 1