

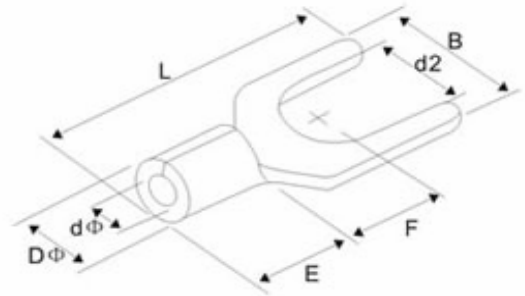

Technical Specification

Maximum Electrical Ratings:	75°C / 600V
Maximum Electrical Ratings:	22-16AWG/ 0,5-1,5mm ² 19A
	16-14AWG/ 1,5-2,5mm ² 27A
	14-12AWG/ 2,5-4,0mm ² 37A
	12-10AWG/4-6mm ² 48A
Terminal Body:	Copper
Insulation:	Non Isolation
Plating:	Tin

Technical Drawing



This Dimensions are for 12~10 AWG / 4,0~6,0mm²

Order Code	Stud Size	d2	B	L	F	E	DØ	dØ							Color
A0	#6	3,7	8,3	19,5	7,5	6,8	5,6	3,4							without plastic
A1	#8	4,3	8,3	19,5	7,5										
A2	#8	4,3	9,0	19,5	7,5										
A3	#10	5,3	9,0	19,5	7,5										
A4	1/4	6,5	9,0	19,5	7,5										
A5	1/4	6,5	12,0	25,5	12,0										
A6	5/16	8,5	14,0	24,5	11,5										
A7															
A8															
A9															
B0															
B1															
B2															
B3															

Ordering Information

Serie	Order Code	ROHS	Packing			
-------	------------	------	---------	--	--	--

N38009	A0	R	BU102			
---------------	-----------	----------	--------------	--	--	--

look table	R= ROHS conform	BU102 1000PCs in one poly bag
	N= Non ROHS conform	

Fork Bare end NON-Insulated	
Part No.:	N38009
Customer:	

DRW:	Jason	CHKD	Jules	MATL:	Wu	DATE	15.03.2010
APPD:	Join			FINISH	Shieh	Sheet	1 from 1