

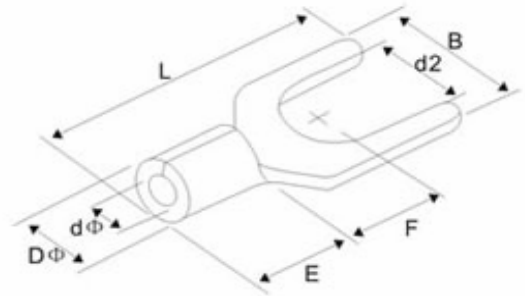

**Technical Specification**

Maximum Electrical Ratings:	75°C / 600V
Maximum Electrical Ratings:	22-16AWG/ 0,5-1,5mm <sup>2</sup> 19A
	16-14AWG/ 1,5-2,5mm <sup>2</sup> 27A
	14-12AWG/ 2,5-4,0mm <sup>2</sup> 37A
	12-10AWG/4-6mm <sup>2</sup> 48A
Terminal Body:	Copper
Insulation:	Non Isolation
Plating:	Tin

**Technical Drawing**



This Dimensions are for 16~14 AWG / 1,5~2,5mm<sup>2</sup>

Order Code	Stud Size	d2	B	L	F	E	DØ	dØ							Color
A0	#4	3,2	5,7	16,0	6,5	4,8	4,1	2,4							without plastic
A1	#6	3,7	5,7	16,0	6,5										
A2	#6	3,7	6,4	16,0	6,5										
A3	#8	4,3	6,4	16,0	6,5										
A4	#8	4,3	7,2	16,0	6,5										
A5	#8	4,3	8,1	16,0	6,5										
A6	#10	5,3	8,1	16,0	6,5										
A7	#10	5,3	9,5	16,0	6,5										
A8	1/4	6,5	9,5	16,0	6,5										
A9	1/4	6,5	12,0	22,0	11,0										
B0	5/16	8,5	14,0	23,5	12,5										
B1															
B2															
B3															

**Ordering Information**

Serie	Order Code	ROHS	Packing			
<b>N38007</b>	<b>A0</b>	<b>R</b>	<b>BU102</b>			

look table	R= ROHS conform	<b>BU102</b> 1000PCs in one poly bag
	N= Non ROHS conform	

**Fork Bare end NON-Insulated**

Part No.: **N38007**

Customer:

DRW:	Jason	CHKD	Jules	MATL:	Wu	DATE	15.03.2010
APPD:	Join			FINISH	Shieh	Sheet	1 from 1