

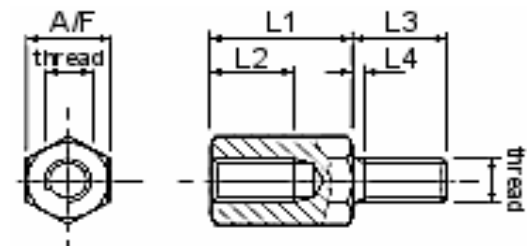

**Technical Description**

Material: Steel / 12L14  
 TYPE: Male/ Female  
 Outside Thread: M5  
 Inside Thread: M5

**Drawing**



Dimensions (mm)					
Order Code	L1	L2	L3	L4	A/F
A010	10	6	8	1,6	8
A011	11	6	8	1,6	8
A012	12	8	8	1,6	8
A013	13	8	8	1,6	8
A014	14	8	8	1,6	8
A015	15	8	8	1,6	8
A016	16	8	8	1,6	8
A017	17	8	8	1,6	8
A018	18	8	8	1,6	8
A019	19	8	8	1,6	8
A020	20	8	8	1,6	8
A025	25	10	10	1,6	8
A030	30	10	10	1,6	8
A035	35	10	10	1,6	8
A040	40	10	10	1,6	8
A045	45	10	10	1,6	8

Dimensions (mm)					
Order Code	L1	L2	L3	L4	A/F
A050	50	10	10	1,6	8
A055	55	10	10	1,6	8
A060	60	10	10	1,6	8
A065	65	10	10	1,6	8
A070	70	10	10	1,6	8
<b>Other length please contact EDCON</b>					

**Hexagonal Pillars Material Steel  
Size M5**

Part No.: **N43026**

Customer:

DRW:	Jason	CHKD	Wilson	MATL:	Wilson	TOLERANCE	Mason	DATE	10.04.2009
APPD:	Schumi			FINISH	Jamy		Sheet No.	1 from 2	

# EDCON-COMPONENTS



## Ordering Informations

Serie	Length Code	Material	ROHS	Packing		
N43026	A005	ST	R	BU101		

A005 ~ xxxx	ST= Steel	R= ROHS Conform	BU101= Bulk-Ware 100PCS
		N= NON ROHS Conform	BU102= Bulk-Ware 1000PCS

<b>Hexagonal Pillars Material Steel Size M5</b>
Part No.: <b>N43026</b>

DRW:	Jason	CHKD	Wilson	MATL:	Wilson	TOLERANCE	Mason	DATE	10.04.2009	Customer:
APPD:	Schumi			FINISH	Jamy		Sheet No.	2 from 2		