

EDCON-COMPONENTS

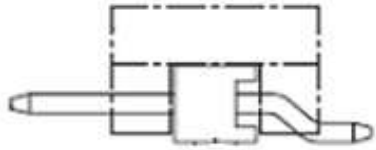

Specifications

Current Rating:	1,5 Ampere
Insulator Resistance:	5000 Megaohm min.
Dielectric Withstanding:	AC 500V
Operating Temperature:	.-40°C to +105°C
Contact Material:	Copper, Alloy
Insulator Material:	P.B.T / PA6T
Standard:	PBT
Contact Plating:	Tin, Gold or Selective Plated
Standard:	Gold Flash Overall
Selectiv Plating:	Gold flash plated on contact area / tin plated on solder area
Max. Prozessing Temp.	230°C for 60 seconds

Drawing (dimensions all into mm)

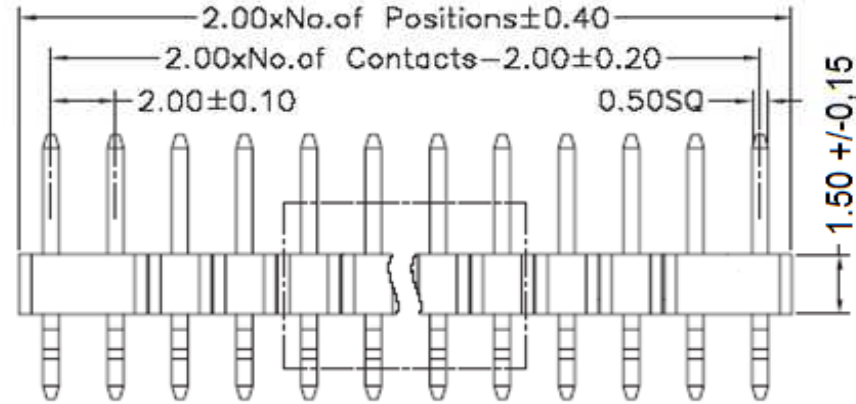

P.C.B Layout

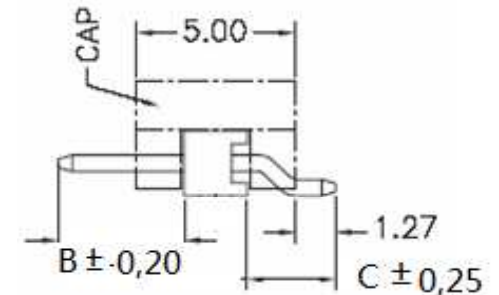
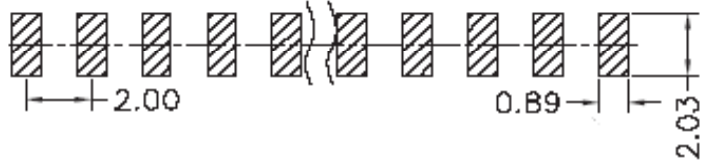

PIN Header / Single Row / Single Body / Pitch 2,00mm

Part No.: **T51B1072-**

Customer:

DRW:	Jason	CHKD	Wilson	MATL:	Wilson	TOLERANCE	Mason	DATE	04.04.2022
APPD:	Schumi			FINISH	Jamy		Sheet No.	1 from 4	

EDCON-COMPONENTS

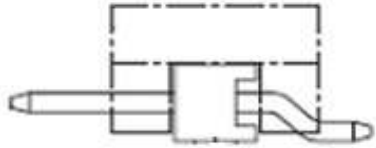

Pin Code length table free configuration

Order Code	Dimension (mm)			
	B	C		
A01	4,00	2,80		
A02	3,20	2,80		
A03	4,00	3,30		
A04	5,50	3,30		
A05				
A06				
A07				
A08				
A09				
A10				
A11				
A12				
A13				
A14				
A15				
A16				
A17				
A18				
A19				
A20				
A21				
A22				

Order Code	Dimension (mm)		
	B		
A23			
A24			
A25			
A26			
A27			
A28			
A29			
A30			
A31			
A32			
A33			
A34			
A35			
A36			
A37			
A38			
A39			
A40			
A41			
A42			
A43			
A44			

Order Code	Dimension (mm)		
	B		
A45			
A46			
A47			
A48			
A49			
A50			
A51			
A52			
A53			
A54			
A55			
A56			
A57			
A58			
A59			
A60			
A61			
A62			
A63			
A64			
A65			
A66			

PIN Header / Single Row / Single Body / Pitch 2,00mm

Part No.: **T51B1072-**

Customer:

DRW:	Jason	CHKD	Wilson	MATL:	Wilson	TOLERANCE	Mason	DATE	04.04.2022
APPD:	Schumi			FINISH	Jamy		Sheet No.		2 from 4

EDCON-COMPONENTS

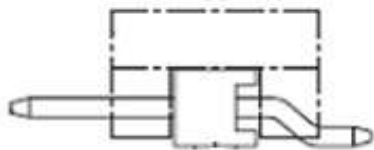

Ordering Informations

Serie	No. of Pos.	Construction	Contact Plating	Material	Locating Peg	Pin Length Order Code	ROHS	Packing		
-------	-------------	--------------	-----------------	----------	--------------	-----------------------	------	---------	--	--

T51B1072-	XX	RS	G0	PB	N	A01	R	BU		
------------------	-----------	-----------	-----------	-----------	----------	------------	----------	-----------	--	--

XX = total pin of header	RS = Right Angle SMT	G0 = Gold Flash (Standard)	PB =P.B.T (Standard)	N = without Peg	look table page 2	N =NO ROHS	BU = Bulk (Standard)
		T0 = Tin plated	PA = Polyester 6T			R =ROHS conform	TU = Tube w/o Cap
		GA = 10µ Gold Plating	NY = Nylon 6T				TC = Tube w. pic and Place Cap
		GB = 15µ Gold Plating					TY = Tray packing w/o Cap
		GC = 20µ Gold Plating					TR = Tape/Reel w. pic and Place Cap
		S0 = Selectiv Plating Gold Flash / Tin					TF = Tape/Reel w. Mylar or Kapton Foil for PIC and PLACE
		TN = Tin Plated					

ORDER CODE = TF with PIC and PLACE FILM instead CAP

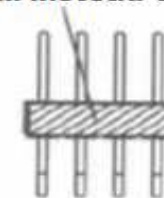

PIN Header / Single Row / Single Body / Pitch 2,00mm

Part No.: **T51B1072-**

Customer:

DRW:	Jason	CHKD	Wilson	MATL:	Wilson	TOLERANCE	Mason	DATE	04.04.2022
APPD:	Schumi			FINISH	Jamy		Sheet No.		3 from 4

www.edcon-components.com

email: info@edcon-components.com

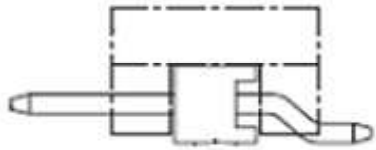

Soldering Profile for Lead Free Soldering

Classification Reflow Profile (JEDEC J-STD-020C)

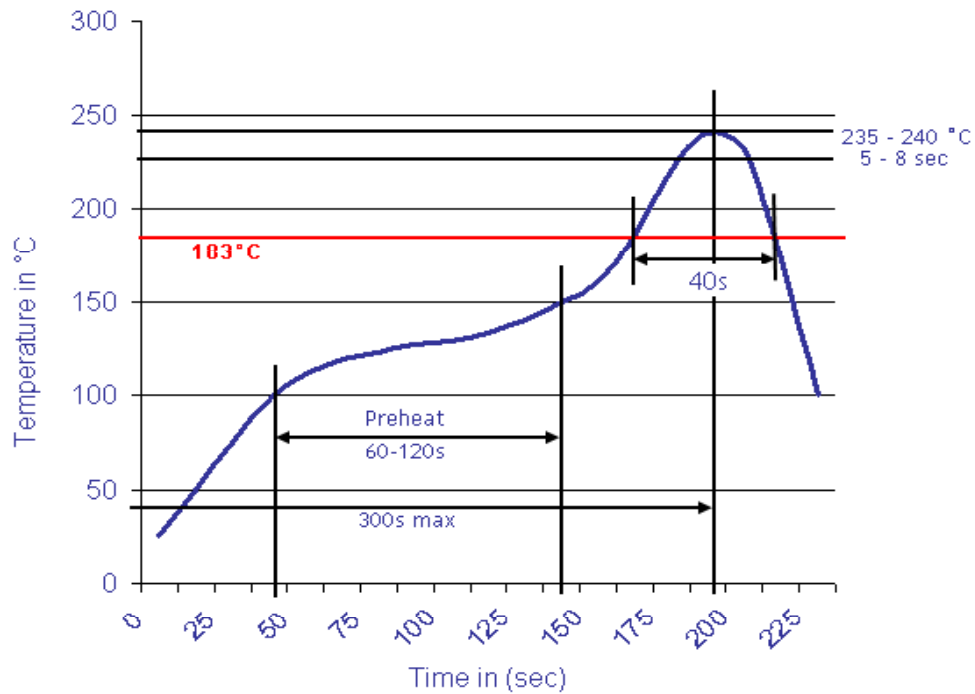

Classification Reflow Profile (JEDEC J-STD-020C)

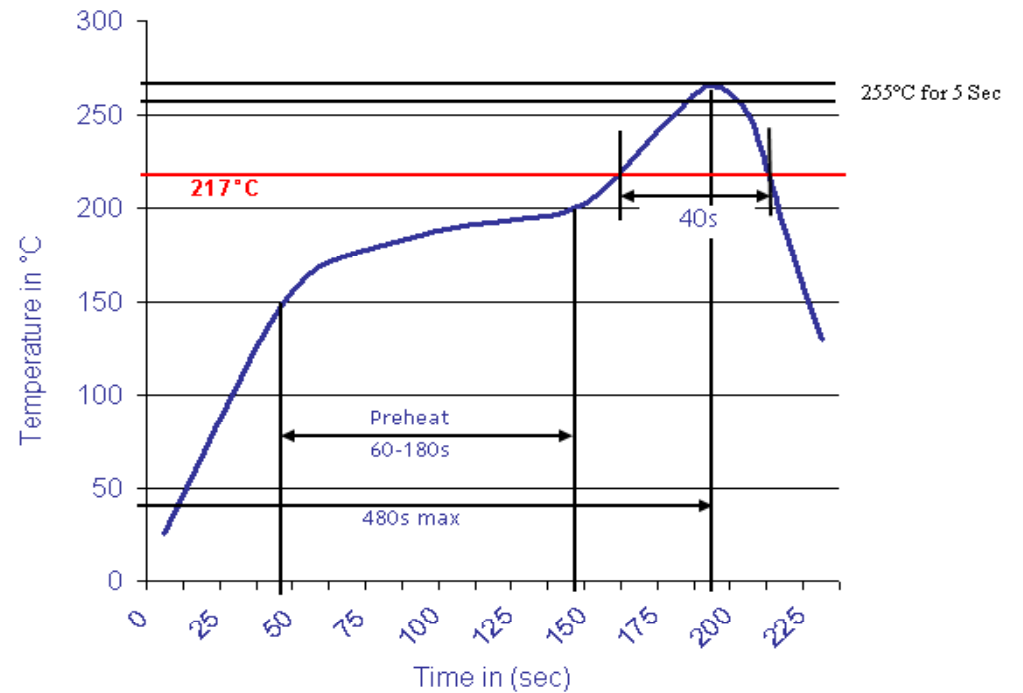

PIN Header / Single Row / Single Body / Pitch 2,00mm

Part No.: **T51B1072-**

DRW:	Jason	CHKD	Wilson	MATL:	Wilson	TOLERANCE	Mason	DATE	04.04.2022
APPD:	Schumi			FINISH	Jamy		Sheet No.	4 from 4	Customer: