

# EDCON-COMPONENTS



## Technical Discription

Temperature Range: ABS= -40°C ~ +85°C  
 PC= -40°C ~ +120°C  
 Protection Degree IP66-67

Draw latch and hinge made of stainless steel hardly break in high frequency in opening and shutting.

We raise hinge and draw latch dimensions in case of enclosures size elevation. For that reason our enclosure can prevent sinking and secure airtight ability in opening and shutting.

In taking goods our of a works our enclosures fitted draw latch and hinge exactly secure a complete airtight ability and useful opening and closing.

Our Enclosure can be used in poor and dangerous industrial circumstances. As we apply shockproof material to our enclosures and make up for structures of our enclosures.



Dimension (mm)												
W1	W2	W3	W4	H1	H2	H3	H4	D1	D2	D3	M1	M2
200	192	182	160	150	142	132	0	80	50	111,5	129	179

**Sealed Plastic Enclosure  
 200 x 150 x 130mm**

Part No.: **H23035**

DRW:	Jason	CHKD	Wilson	MATL:	Wilson	TOLERANCE	Mason	DATE	12.02.2010
APPD:	Schumi			FINISH	Jamy		Sheet No.	1 from 3	Customer:

[www.edcon-components.com](http://www.edcon-components.com)

email: info@edcon-components.com

# EDCON-COMPONENTS



## Technical Drawing

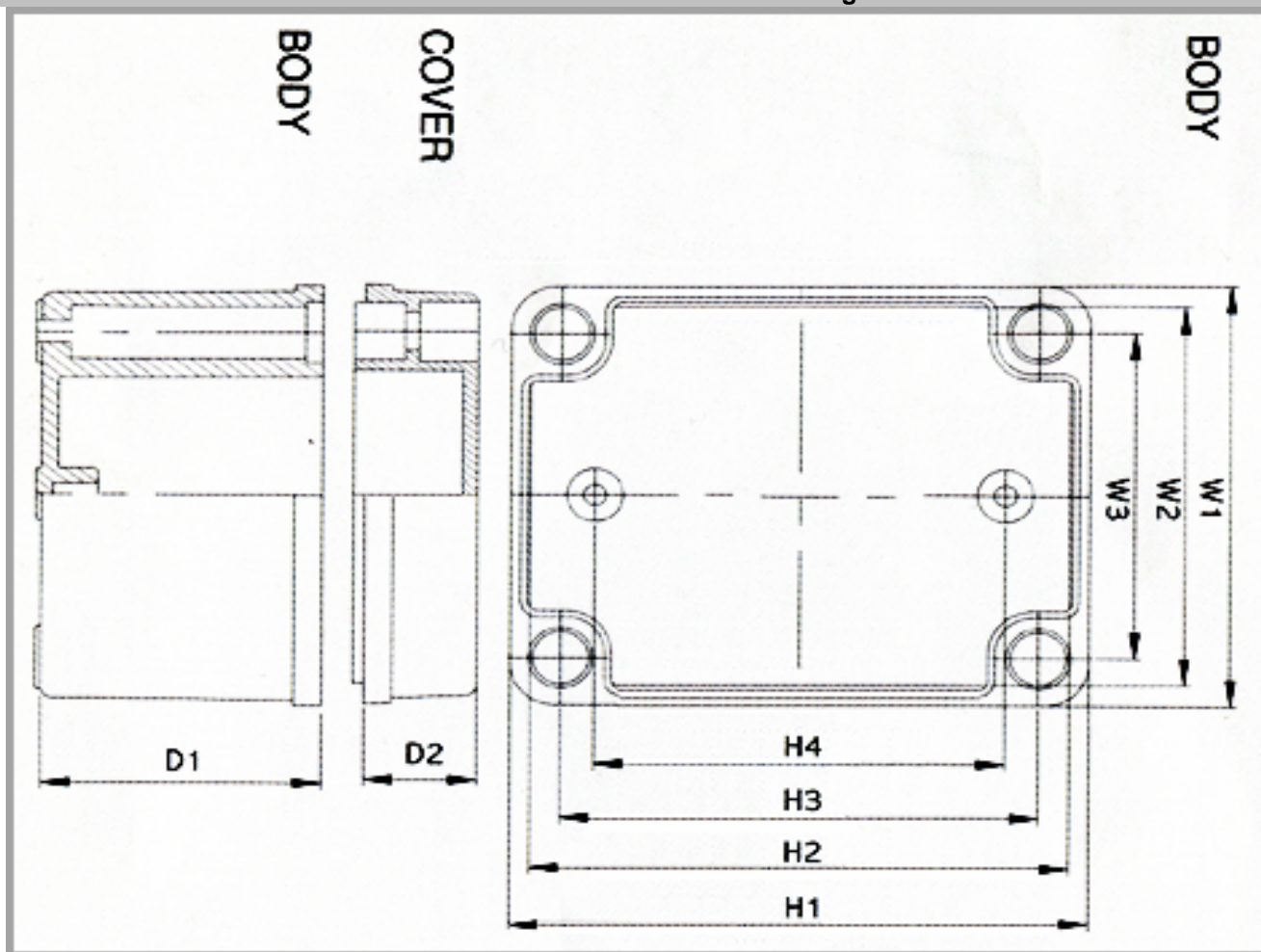

<b>Sealed Plastic Enclosure 200 x 150 x 130mm</b>	
Part No.:	<b>H23035</b>
Customer:	

DRW:	Jason	CHKD	Wilson	MATL:	Wilson	TOLERANCE	Mason	DATE	12.02.2010
APPD:	Schumi			FINISH	Jamy		Sheet No.	2 from 3	

[www.edcon-components.com](http://www.edcon-components.com)

email: [info@edcon-components.com](mailto:info@edcon-components.com)



Accessories for Enclosures H230xx Serie

Ordering Informations

Serie	Material Base	Material Cover	Color Base	Color Cover	ROHS	Packing				
-------	---------------	----------------	------------	-------------	------	---------	--	--	--	--

<b>H23035</b>	<b>A</b>	<b>A</b>	<b>G</b>	<b>G</b>	<b>R</b>	<b>S</b>				
---------------	----------	----------	----------	----------	----------	----------	--	--	--	--

<b>A= ABS</b>	<b>A= ABS</b>	<b>G= Gray</b>	<b>G= Gray</b>	<b>R= ROHS Conform</b>	<b>S= Standard Packing</b>
<b>P= Polycar - bonat</b>	<b>P= Polycar - bonat</b>	<b>T= Transparent</b>	<b>T= Transparent</b>	<b>N= NON ROHS Conform</b>	<b>I= Individual Packing</b>

<b>Sealed Plastic Enclosure 200 x 150 x 130mm</b>
Part No.: <b>H23035</b>
Customer:

DRW:	Jason	CHKD	Wilson	MATL:	Wilson	TOLERANCE	Mason	DATE	12.02.2010
APPD:	Schumi			FINISH	Jamy		Sheet No.		3 from 3