

Technical Specification

Electrical Characteristics

Standard Resistance Range: 100Ω to 5,0MΩ
 Standard Resistance Tolerance: 20% Standard
 20% Standard from 100Ω ~ 1,0MΩ
 30% Standard from 1,0MΩ ~ 5,0MΩ
 Withstang Voltage: 250VDC
 Rated Power: 0,25W (lin) 0,12W (no lin)
 Taper: A, B, C,
 Residual resistance: ≤5% Rn (2 Ω min)
 Equivalent noise resistance: ≤3% Rn (3 Ω min)
 Operating Temperature: -25°C ~ +70°C

Physical Characteristics

Mechanical rotation angle: 265°C +/- 5°
 Electrical rotation angle: 245°C +/- 20°
 Torque: 0,5 ~ 2,5Ncm
 Stop Torque: > 4Ncm
 Standard Lifetime: 500cycles
 Long life time: 10000cycles

Features

Carbon resistive element
 Dust Proof enclosure
 Polyester Substrate
 Long Life Model available
 Supplied in magazines for automatic insertion

Technical Dimensions Alternative Brand ACP Type CA 14H

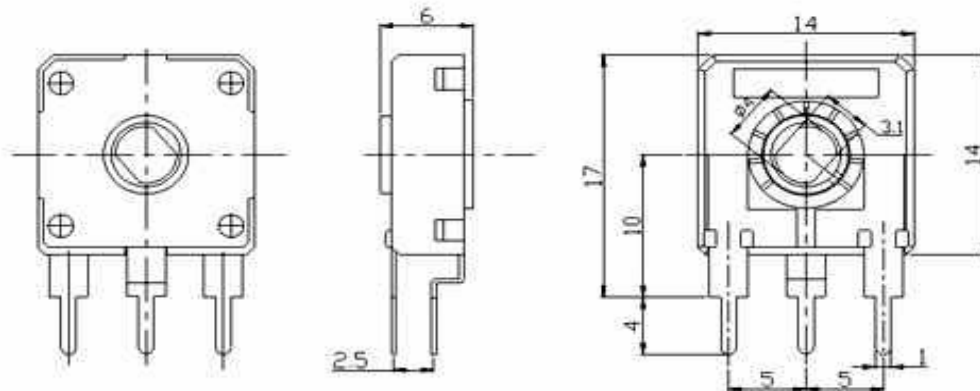

PCB Layout

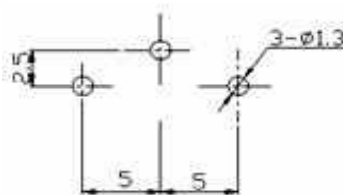

Physical Structure

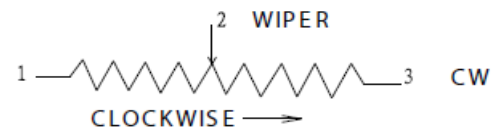

**14mm THT Single-Turn
 Trimmer Type CA14H2,5**

Serie No.: **X17003**

Customer:

DRW:	Jason	CHKD	Jules	MATL:	Wu	DATE	06.09.2009
APPD:	Join			FINISH	Shieh	Sheet	1 from 3

Copyright by EDCON-COMPONENTS H.Schmitt

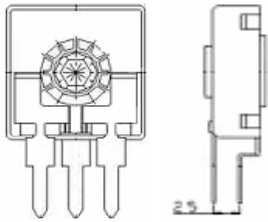

Rotor Style Table

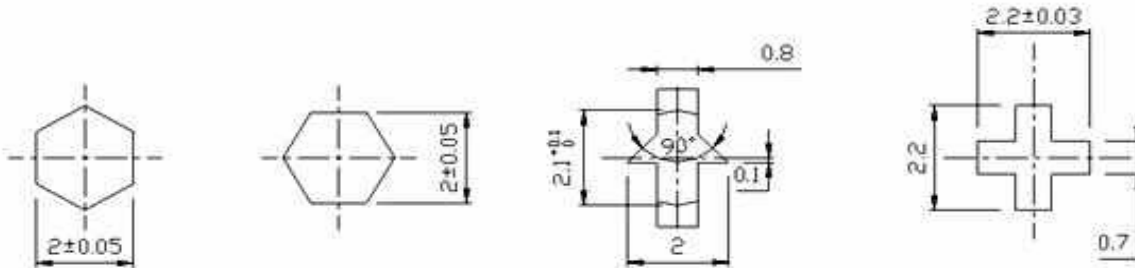

Range Code Table

Ordering Code	Range
100	10Ω
200	20Ω
500	50Ω
101	100Ω
201	200Ω
501	500Ω
102	1,0KΩ
202	2,0KΩ
502	5,0KΩ
103	10KΩ
203	20KΩ
253	25KΩ
503	50KΩ
104	100KΩ
204	200KΩ
254	250KΩ
504	500KΩ
105	1,0MΩ
205	2,0MΩ

**14mm THT Single-Turn
 Trimmer Type CA14H2,5**

Serie No.: **X17003**

Customer:

DRW:	Jason	CHKD	Jules	MATL:	Wu	DATE	06.09.2009
APPD:	Join			FINISH	Shieh	Sheet	2 from 3

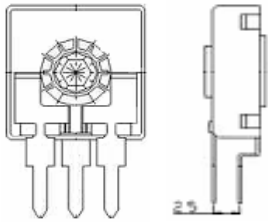

Soldering Profile

Classification Reflow Profile (JEDEC J-STD-020C)

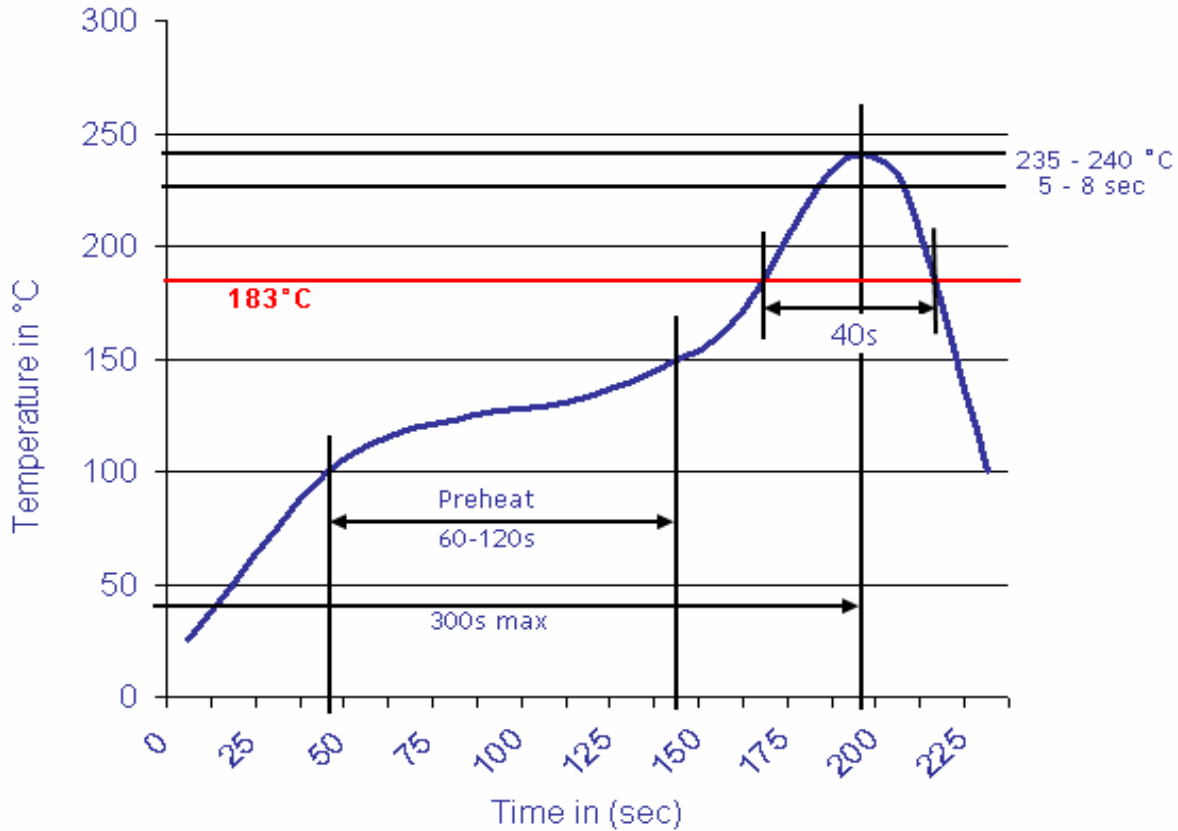

Ordering Information

Serie	Ordering Code	Tolerance	Rotor Style	Taper	Lifetime	ROHS	Packing
-------	---------------	-----------	-------------	-------	----------	------	---------

X17003	101	M	G	A	1	R	BU101
---------------	------------	----------	----------	----------	----------	----------	--------------

101= 100Ω	M= Tol. 20%	G= Hexagonal Style 1	A= Linear	1= 500 cycles Standard	R= ROHS conform	BU101= Bulk-Ware 100PCS
	N= Tol. 30%	M= Hexagonal Style 2	B= Logarithmisch	2= 10000 cycles	N=NON ROHS conform	
		L= Screw Driver	C= Anti Logarithmisch			TU= Tube Packing
		K= Cross Style				

14mm THT Single-Turn Trimmer Type CA14H2,5	
Serie No.:	X17003
Customer:	

DRW:	Jason	CHKD	Jules	MATL:	Wu	DATE	06.09.2009
APPD:	Join			FINISH	Shieh	Sheet	3 from 3