

# Data Sheet

## Screwless Terminal Block

**Pitch: 3,81 mm**

**Serie: A14H106**

### Customer Information for special Item

**EDCON Customer : 0**

**Customer Version No. : 0**

# EDCON-COMPONENTS



## Technical Discription

## Drawing (Dimension in mm)

### Electrical

Rated voltage 300V  
Rated current 8A

Withstanding voltage 1,6kv

### Mechanical

Temperature range -40°C ~ 115°C

### Dimensions

Pitch 3,81mm  
Poles 2P - 24P

### Material

Housing Thermoplastic UL94V-0  
Pin header PhBz Tin Plated

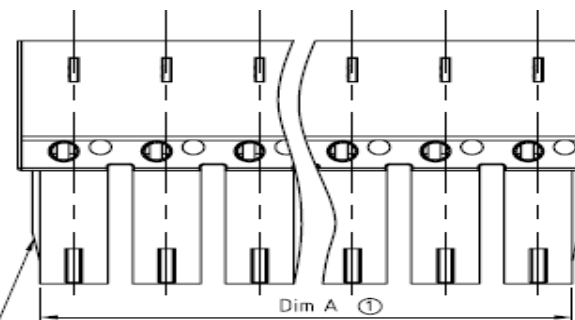
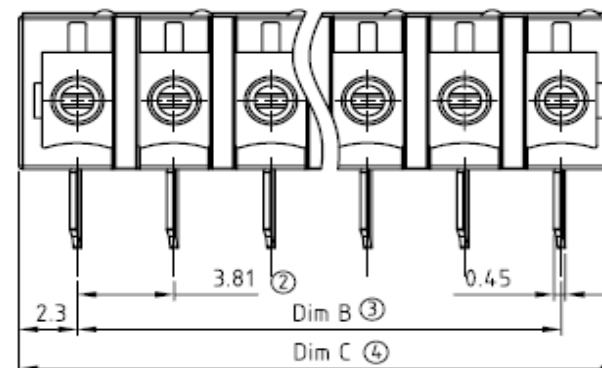

2P to 6P with wedge,  
above 7P without wedge.

### Screwless Terminal Block

Part No.: **A14H106**

Customer:

DRW:	Jason	CHKD	Wilson	MATL:	Wilson	TOLERANCE	Mason	DATE	17.02.2014
APPD:	Schumi			FINISH	Jamy		Sheet No.	1 from 4	

# EDCON-COMPONENTS



Drawing (Dimension in mm)

Dimensions (mm)

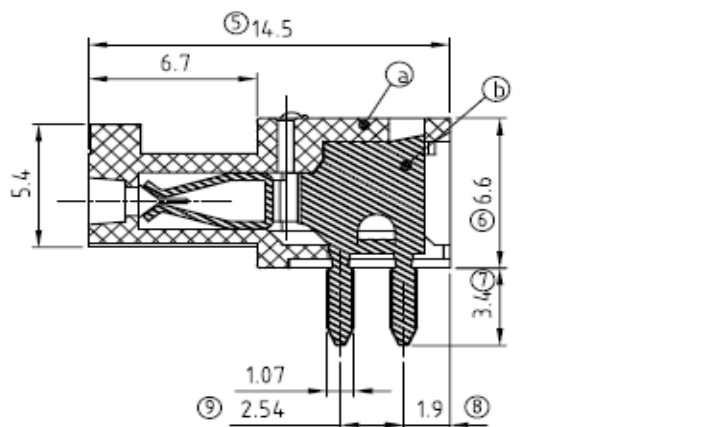

No. of Pos.	A	Tol. P	B	Tol. P
02	6,61	± 0,30	3,81	± 0,30
03	10,42	± 0,30	7,62	± 0,30
04	14,23	± 0,30	11,43	± 0,30
05	18,04	± 0,30	15,24	± 0,30
06	21,85	± 0,30	19,05	± 0,30
07	25,66	± 0,30	22,86	± 0,30
08	29,47	± 0,30	26,67	± 0,30
09	33,28	± 0,30	30,48	± 0,30
10	37,09	± 0,30	34,29	± 0,30
11	40,90	± 0,30	38,10	± 0,30
12	44,71	± 0,30	41,91	± 0,30
13	48,52	± 0,30	45,72	± 0,30
14	52,33	± 0,30	49,53	± 0,30
15	56,14	± 0,30	53,34	± 0,30
16	59,95	± 0,30	57,15	± 0,30
17	63,76	± 0,30	60,96	± 0,30
18	67,57	± 0,30	64,77	± 0,30
19	71,38	± 0,30	68,58	± 0,30
20	75,19	± 0,30	72,39	± 0,30
21	79,00	± 0,30	76,20	± 0,30
22	82,81	± 0,30	80,01	± 0,30
23	86,62	± 0,30	83,82	± 0,30
24	90,43	± 0,30	87,63	± 0,30

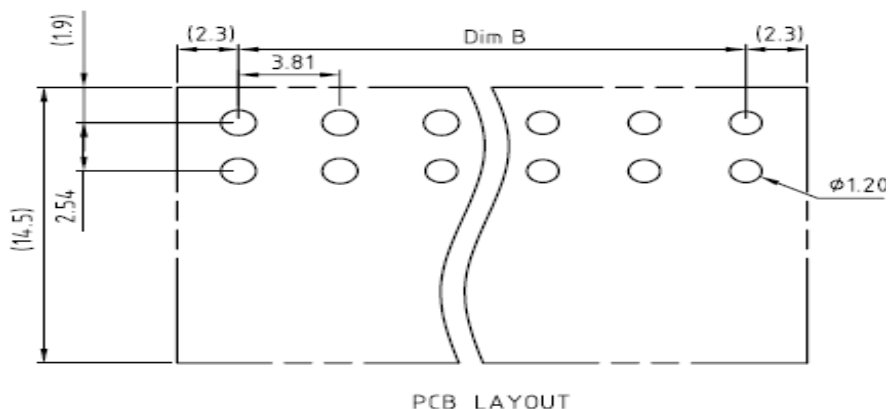

## Screwless Terminal Block

Part No.: **A14H106**

Customer:

DRW:	Jason	CHKD	Wilson	MATL:	Wilson	TOLERANCE	Mason	DATE	17.02.2014
APPD:	Schumi			FINISH	Jamy		Sheet No.		2 from 4

# EDCON-COMPONENTS



## Ordering Informations

Serie	No. of Pos.	Body Color	Approval	Approval Code	ROHS	Packing	EDCON Cust. No.	Customer Version		
-------	-------------	------------	----------	---------------	------	---------	-----------------	------------------	--	--

<b>A14H106</b>	<b>02</b>	<b>GN</b>	<b>N</b>	<b>N</b>	<b>R</b>	<b>B</b>				
----------------	-----------	-----------	----------	----------	----------	----------	--	--	--	--

Pitch 3,81	<b>02</b> = Number of Pos. Standard 2 ~ 24Pos.	<b>GY</b> = Gray (Standard)  <b>GN</b> = Green  <b>OR</b> = Orange  <b>BK</b> = Black	<b>N</b> = No Approval  <b>1</b> = Approval for Material  <b>2</b> = Approval for Terminal Block	<b>N</b> = NON Approval  <b>A</b> = UL /UR Approval Please consult EDCON for available  <b>B</b> = VDE Approval Please consult EDCON for available  <b>C</b> = TÜV Approval Please consult EDCON for available	<b>R</b> = ROHS Conform  <b>N</b> = NON ROHS Conform	<b>B</b> = Standard Package  <b>I</b> = Individual Package	<b>xxxxxx</b> = Customer Number	<b>xxx</b> = Customer Version ??(Printing)		
---------------	---	---	--	--	--	--	---------------------------------	--	--	--

**Screwless Terminal Block**

Part No.: **A14H106**

DRW:	Jason	CHKD	Wilson	MATL:	Wilson	TOLERANCE	Mason	DATE	17.02.2014
APPD:	Schumi			FINISH	Jamy		Sheet No.		3 from 4

Customer:



Soldering Profile Curve

Classification Reflow Profile (JEDEC J-STD-020C)

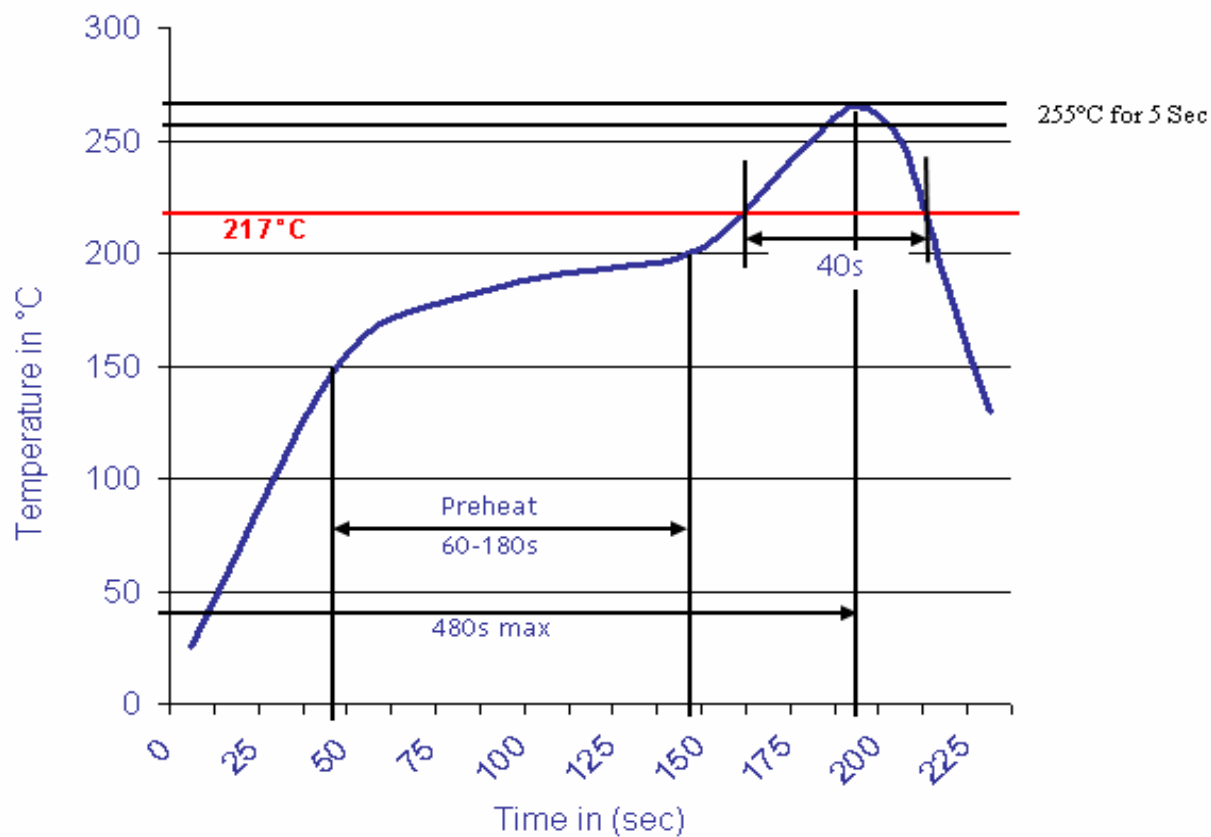

**Screwless Terminal Block**

Part No.: **A14H106**

DRW:	Jason	CHKD	Wilson	MATL:	Wilson	TOLERANCE	Mason	DATE	17.02.2014
APPD:	Schumi			FINISH	Jamy		Sheet No.	4 from 4	Customer:



