

EDCON-COMPONENTS

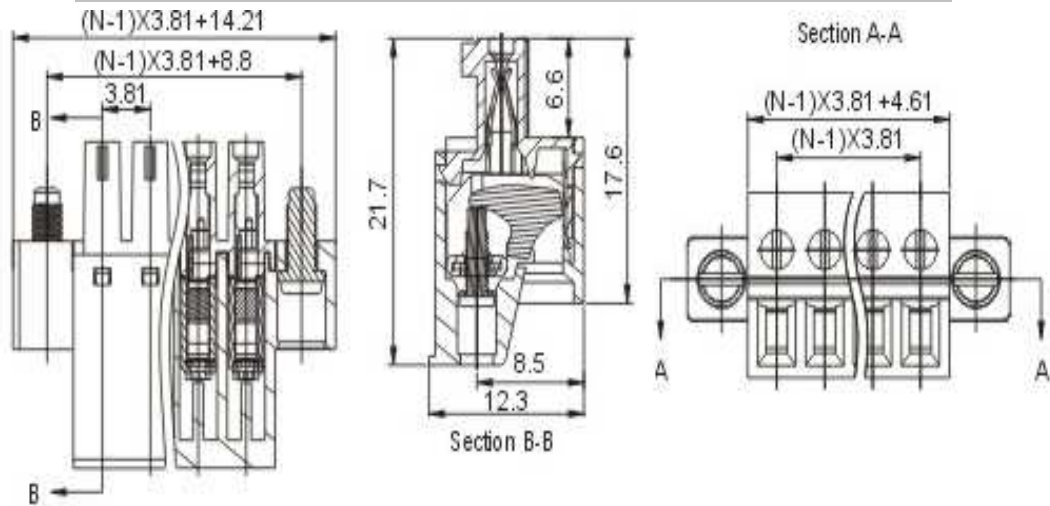

Drawing



P.C.B. Layout

Specification

APPROVAL		UL [®] US	CE
Electrical	Standard	UL	IEC
	Rated voltage	300V	250V
	Rated current	8A	7A
	Wire range	28-16 AWG	05.-1.5mm ²
	Withstanding voltage	AC 2000V/1min	
Mechanical	Ambient temperature	-40°C ~ +105°C	
	Strip length	9mm	
	Torque	M2, 0.2Nm (1.7Lb-In.)	
Dimensions	Pitch	3.81mm	
	Poles	2P - 20P	
Material	Housing	PA66 (UL94V-0)	
	Pin header	Phosphor Bronze	
	Screws & Cage	steel, Cr ³⁺ Zn plated	



Certification



Pluggable Terminal Block /	
Pitch 3.81mm	
Part No.:	A14H036
Customer:	

DRW:	Justin	CHKD	Frank	MATL:	Jordan	TOLERANCE	Lord	Date	10.02.2009
APPD:	Pete			FINISH	Mike			Sheet No.	1 from 3

www.edcon-components.com

email: info@edcon-components.com

EDCON-COMPONENTS



Ordering Informations

Serie	-	No. of Pole	Body-Color	-	Customer Request
A14H036	-	XX	XX	-	X
		XX = total	WH - white		
		02	GN - green		
		...	GR - gray		
		20	TP - transparent		
			OR - orange		
			BK - black		
			BL - blue		
			RD - red		
			YW - yellow		
			PG - Phoenix Green		



Certification



Pluggable Terminal Block / Pitch 3.81mm	
Part No.:	A14H036
Customer:	

DRW:	Justin	CHKD	Frank	MATL:	Jordan	TOLERANCE	Lord	Date	10.02.2009
APPD:	Pete			FINISH	Mike			Sheet No.	2 from 3

www.edcon-components.com

email: info@edcon-components.com



Soldering - Profil

Classification Reflow Profile (JEDEC J-STD-020C)

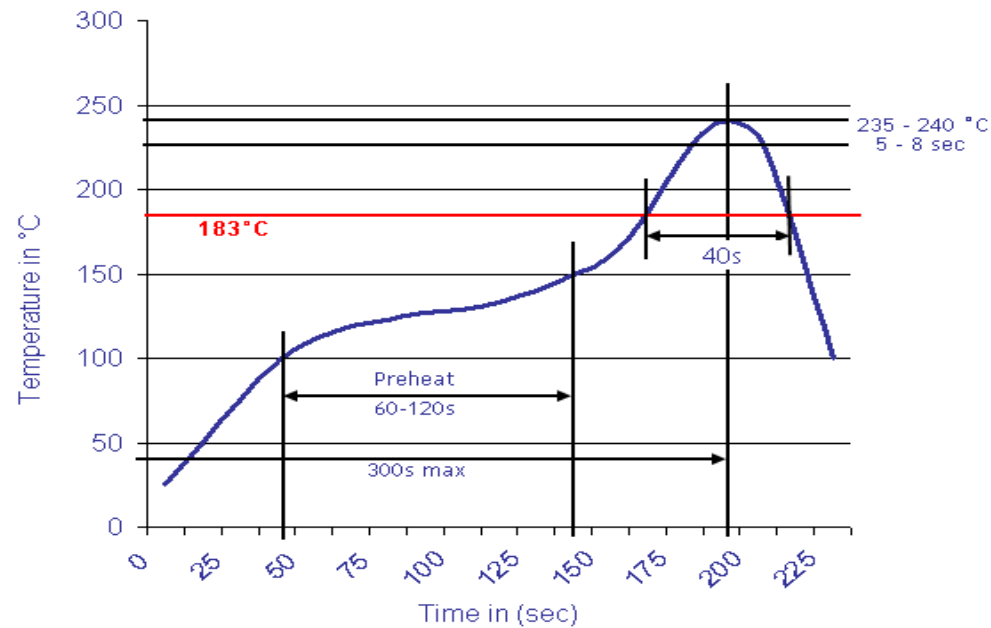

Pluggable Terminal Block /
Pitch 3.81mm

Part No.: A14H036

Customer:

DRW:	Justin	CHKD	Frank	MATL:	Jordan	TOLERANCE	Lord	Date	10.02.2009
APPD:	Pete			FINISH	Mike			Sheet No.	3 from 3