

EDCON-COMPONENTS

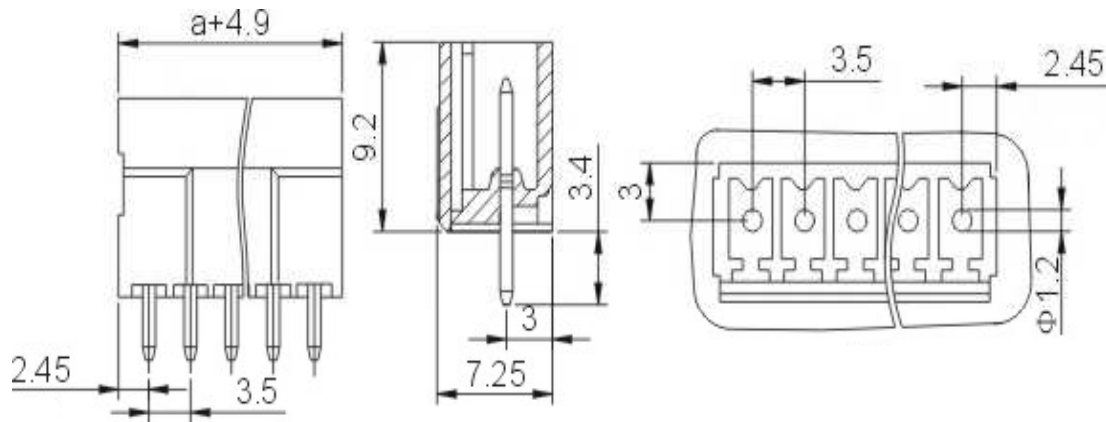

Drawing



P.C.B. Layout

Specification

APPROVAL



Electrical

Standard
 Rated voltage
 Rated current
 Withstanding voltage

UL	IEC
300V	250V
8A	7A
AC 2000V/1min	

Mechanical

Ambient temperature

-40°C ~ +140°C

Dimensions

Pitch
 Poles

3.50mm
 2P - 12P

Material

Housing
 Pin header

PA46 (UL94V-0)
 Brass, Tin plated

Wafer for Pluggable Terminal Block
 Pitch 3.50mm

Part No.: A14G088

Customer:

DRW:	Justin	CHKD	Frank	MATL:	Jordan	TOLERANCE	Lord	Date	15.06.2022
APPD:	Pete			FINISH	Mike			Sheet No.	1 from 3

www.edcon-components.com

email: info@edcon-components.com

EDCON-COMPONENTS



Ordering Informations

Serie	-	No. of Pole	Body-Color	ROHS	Packing	Customer Request
-------	---	-------------	------------	------	---------	------------------

A14G088	-	XX	XX	R	BU	X
		XX = total	WH - white	R = ROHS Conform	BU = Bulk-Ware	
		02	GN - green			
		...	GR - gray	N = NON ROHS Conform	IV = Individual Package	
		12	TP - transparent			
			OR - orange			
			BK - black			
			BL - blue			
			RD - red			
			YW - yellow			
			PG - Phoenix Green			

Wafer for Pluggable Terminal Block	
Pitch 3.50mm	
Part No.:	A14G088
Customer:	

DRW:	Justin	CHKD	Frank	MATL:	Jordan	TOLERANCE	Lord	Date	15.06.2022
APPD:	Pete			FINISH	Mike			Sheet No.	2 from 3

www.edcon-components.com

email: info@edcon-components.com



Soldering - Profil

Classification Reflow Profile (JEDEC J-STD-020C)

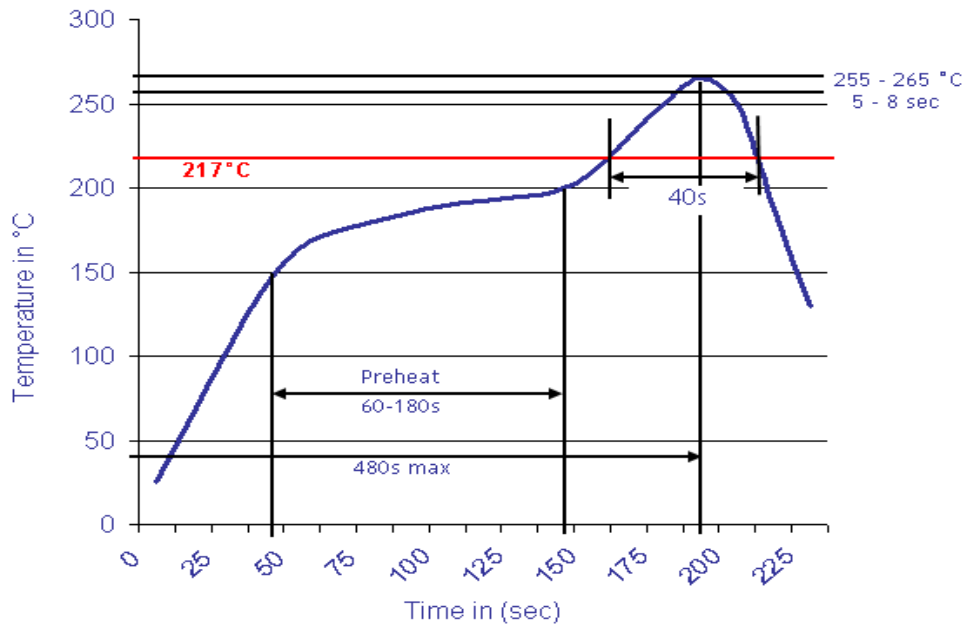

Wafer for Pluggable Terminal Block	
Pitch 3.50mm	
Part No.:	A14G088
Customer:	

DRW:	Justin	CHKD	Frank	MATL:	Jordan	TOLERANCE	Lord	Date	15.06.2022
APPD:	Pete			FINISH	Mike		Sheet No.	3 from 3	

www.edcon-components.com

email: info@edcon-components.com