

EDCON-COMPONENTS

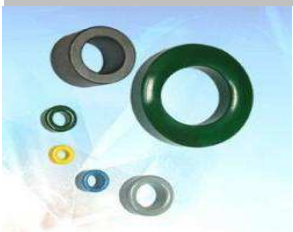

Description

Ring Core are mainly used for coupling transformers balancing coils, fixed coils and filter coils

Dimensions (mm)

Impedance curve

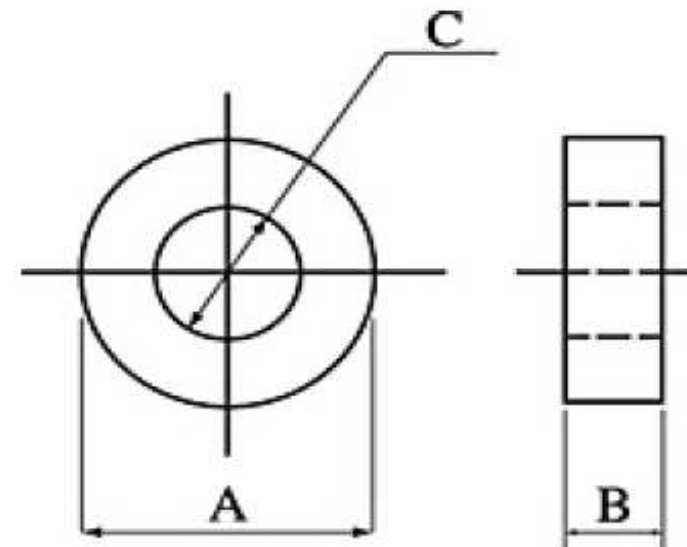
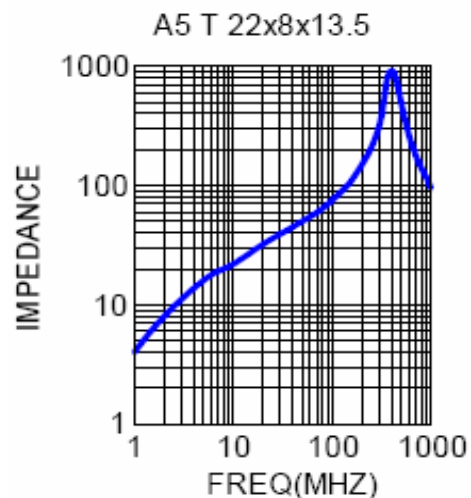
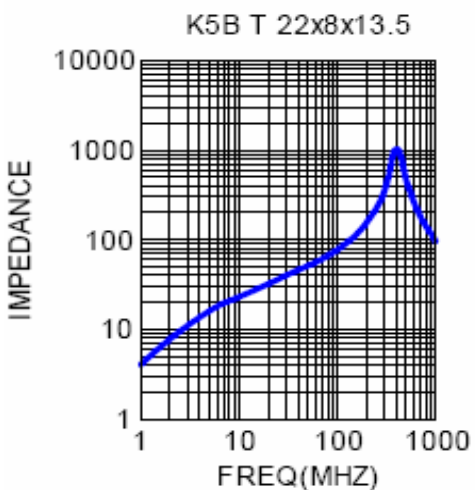

A= 22,0 ± 0,60
 B= 8,0 ± 0,30
 C= 13,5 ± 0,40
 Unit: mm

Other Sizes are available on request

Material K5B

Material A5

Ring Cores

Part No.: **G24134**

Customer:

DRW:	Jason	CHKD	Wilson	MATL:	Wilson	TOLERANCE	Mason	DATE	24.08.2012
APPD:	Schumi			FINISH	Jamy		Sheet No.		1 from 3

www.edcon-components.com

email: info@edcon-components.com

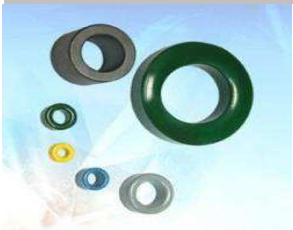

Impedance curve

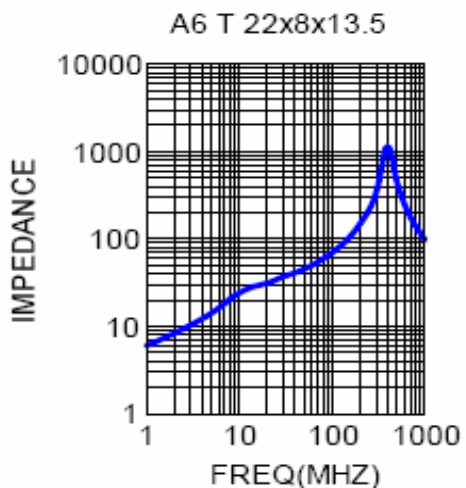

Material A6

Ring Cores

Part No.: **G24134**

Customer:

DRW:	Jason	CHKD	Wilson	MATL:	Wilson	TOLERANCE	Mason	DATE	24.08.2012
APPD:	Schumi			FINISH	Jamy		Sheet No.	2 from 3	

EDCON-COMPONENTS

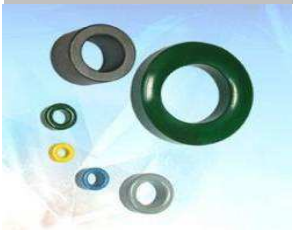

Ordering Informations

Serie	Material	Coating	ROHS	Packing						
-------	----------	---------	------	---------	--	--	--	--	--	--

G24134	-	K5B	E	R	TR					
---------------	---	------------	----------	----------	-----------	--	--	--	--	--

K5B= Material	E= Epoxy	R= ROHS conform	TR= Tray Packing			
A5= Material	P= Parylene					
A6= Material						

Ring Cores
Part No.: G24134
Customer:

DRW:	Jason	CHKD	Wilson	MATL:	Wilson	TOLERANCE	Mason	DATE	24.08.2012
APPD:	Schumi			FINISH	Jamy			Sheet No.	3 from 3