

Description

Ring Core are mainly used for coupling transformers balancing coils, fixed coils and filter coils

Dimensions (mm)

Impedance curve

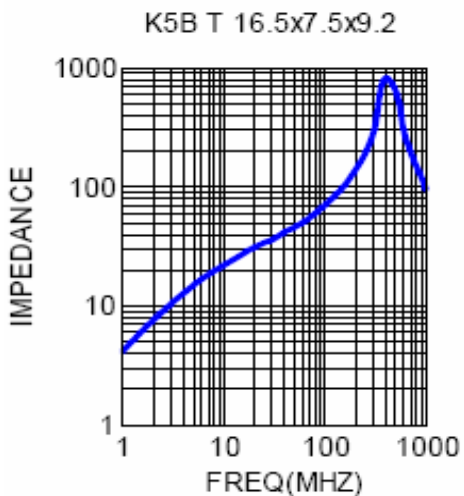

In the moment not available

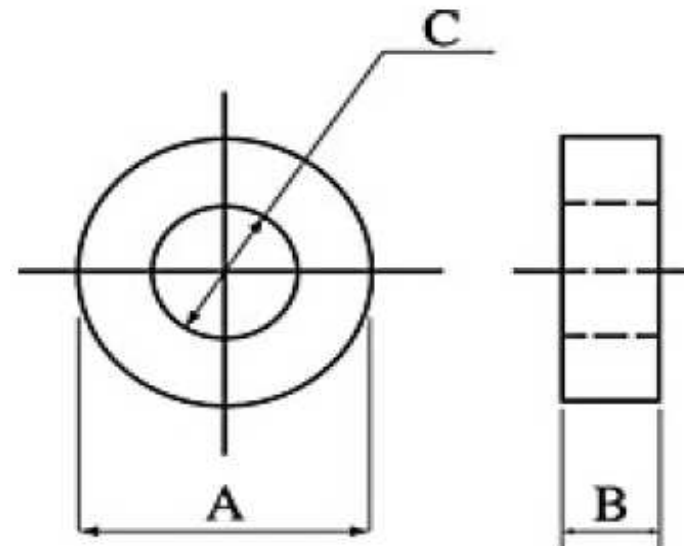

- A= 16,5 ± 0,40
- B= 7,5 ± 0,30
- C= 9,2 ± 0,30
- Unit: mm

Other Sizes are available on request

Material K5B

Material A6

Ring Cores

Part No.: **G24106**

DRW:	Jason	CHKD	Wilson	MATL:	Wilson	TOLERANCE	Mason	DATE	24.08.2012
APPD:	Schumi			FINISH	Jamy		Sheet No.	1 from 2	

Customer: _____
email: info@edcon-components.com

EDCON-COMPONENTS

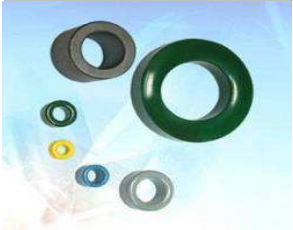

Ordering Informations

Serie	Material	Coating	ROHS	Packing						
G24106	K5B	E	R	TR						

K5B= Material	E= Epoxy	R= ROHS conform	TR= Tray Packing			
	P= Parylene					

Ring Cores	
Part No.:	G24106
Customer:	

DRW:	Jason	CHKD	Wilson	MATL:	Wilson	TOLERANCE	Mason	DATE	24.08.2012
APPD:	Schumi			FINISH	Jamy			Sheet No.	2 from 2

www.edcon-components.com

email: info@edcon-components.com