

# EDCON-COMPONENTS



## Description

Ring Core are mainly used for coupling transformers balancing coils, fixed coils and filter coils

## Dimensions (mm)

### Impedance curve

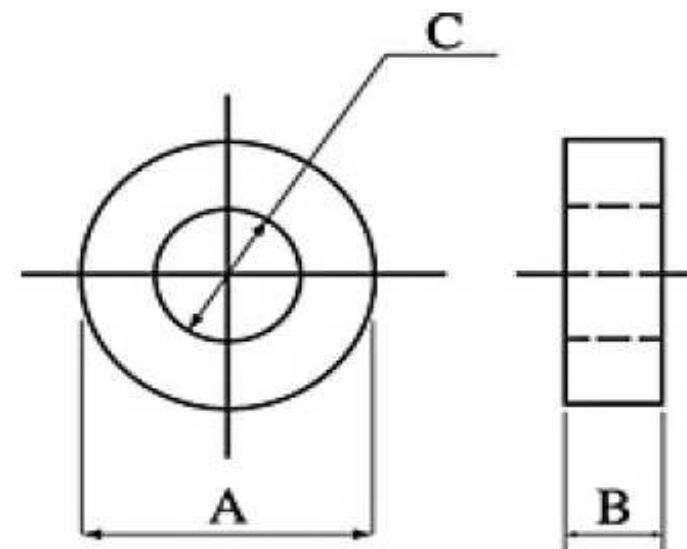
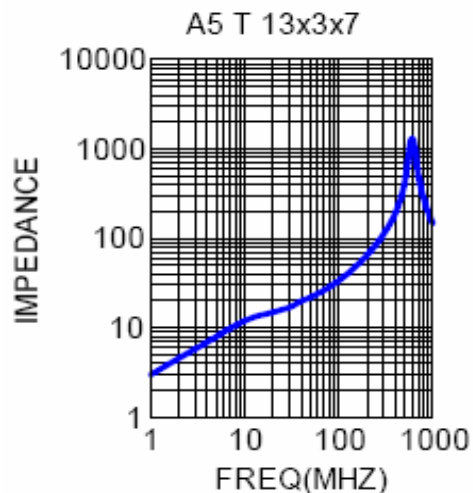
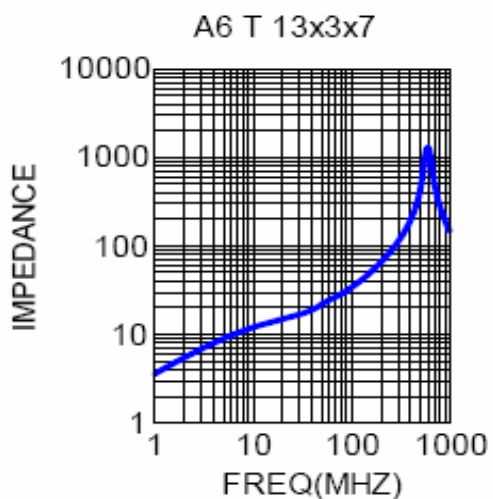

A= 13,3 ± 0,30  
 B= 3,0 ± 0,20  
 C= 7,0 ± 0,30  
 Unit: mm

Other Sizes are available on request

### Material A6

### Material A5

### Ring Cores

Part No.: **G24083**

Customer:

DRW:	Jason	CHKD	Wilson	MATL:	Wilson	TOLERANCE	Mason	DATE	24.08.2012
APPD:	Schumi			FINISH	Jamy		Sheet No.		1 from 3

[www.edcon-components.com](http://www.edcon-components.com)

email: [info@edcon-components.com](mailto:info@edcon-components.com)



**Ordering Informations**

Serie	Material	Coating	ROHS	Packing						
-------	----------	---------	------	---------	--	--	--	--	--	--

<b>G24083</b>	-	<b>A5</b>	<b>E</b>	<b>R</b>	<b>TR</b>					
---------------	---	-----------	----------	----------	-----------	--	--	--	--	--

	<b>E= Epoxy</b>	<b>R= ROHS conform</b>	<b>TR= Tray Packing</b>			
<b>A5= Material</b>	<b>P= Parylene</b>					
<b>A6= Material</b>						

<b>Ring Cores</b>
Part No.: <b>G24083</b>
Customer:

DRW:	Jason	CHKD	Wilson	MATL:	Wilson	TOLERANCE	Mason	DATE	24.08.2012
APPD:	Schumi			FINISH	Jamy		Sheet No.		2 from 2