

EDCON-COMPONENTS



Description

Ring Core are mainly used for coupling transformers balancing coils, fixed coils and filter coils

Dimensions (mm)

Impedance curve

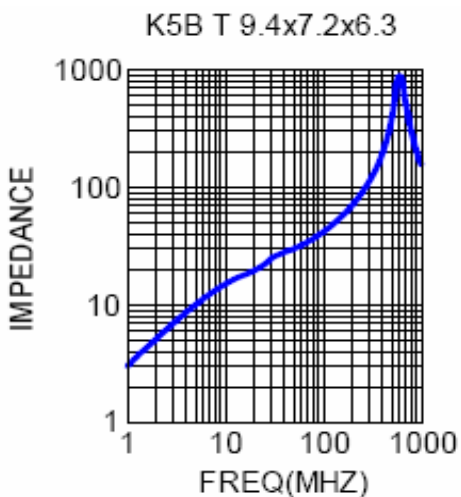

In the moment not available

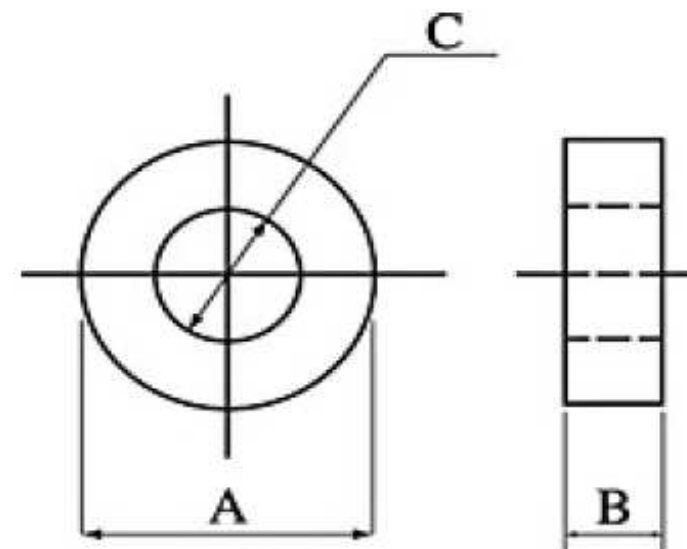

A= 9,40 ± 0,30
 B= 7,20 ± 0,30
 C= 6,30 ± 0,25
 Unit: mm

Other Sizes are available on request

Material K5B

Material A6

Ring Cores

Part No.: **G24058**

DRW:	Jason	CHKD	Wilson	MATL:	Wilson	TOLERANCE	Mason	DATE	24.08.2012
APPD:	Schumi			FINISH	Jamy		Sheet No.	1 from 2	

Customer:
 email: info@edcon-components.com

www.edcon-components.com

EDCON-COMPONENTS



Ordering Informations

Serie	Material	Coating	ROHS	Packing						
-------	----------	---------	------	---------	--	--	--	--	--	--

G24058	-	K5B	E	R	TR					
---------------	---	------------	----------	----------	-----------	--	--	--	--	--

K5B= Material	E= Epoxy	R= ROHS conform	TR= Tray Packing			
	P= Parylene					

Ring Cores
Part No.: G24058
Customer:

DRW:	Jason	CHKD	Wilson	MATL:	Wilson	TOLERANCE	Mason	DATE	24.08.2012
APPD:	Schumi			FINISH	Jamy		Sheet No.		2 from 2