

# EDCON-COMPONENTS

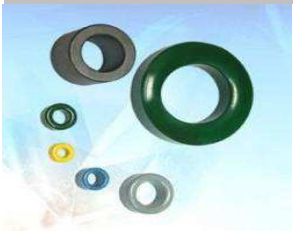

## Description

Ring Core are mainly used for coupling transformers balancing coils, fixed coils and filter coils

## Dimensions (mm)

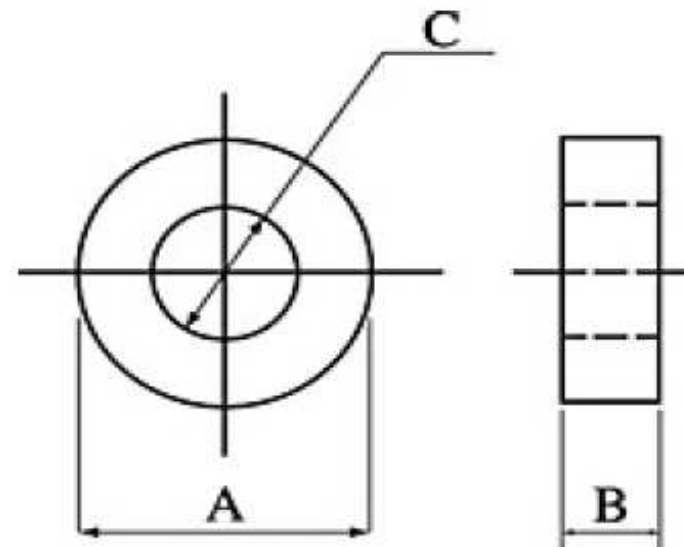

A= 3,50 ± 0,15  
 B= 3,25 ± 0,20  
 C= 1,40 ± 0,15  
 Unit: mm

## Impedance curve

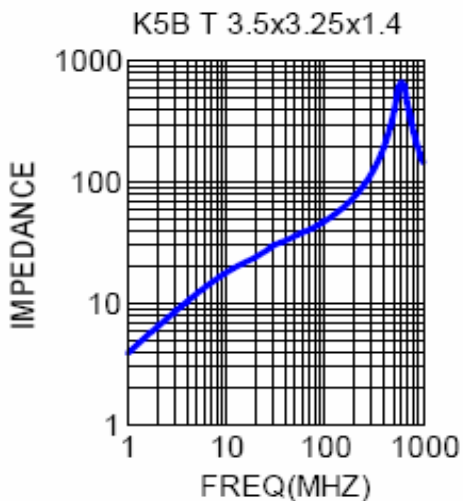

In the moment not available

Other Sizes are available on request

## Material K5B

## Material A6

## Ring Cores

Part No.: **G24017**

DRW:	Jason	CHKD	Wilson	MATL:	Wilson	TOLERANCE	Mason	DATE	24.08.2012	Customer:
APPD:	Schumi			FINISH	Jamy		Sheet No.	1 from 2		

[www.edcon-components.com](http://www.edcon-components.com)

email: [info@edcon-components.com](mailto:info@edcon-components.com)

# EDCON-COMPONENTS

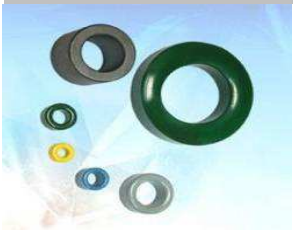

## Ordering Informations

Serie	Material	Coating	ROHS	Packing						
-------	----------	---------	------	---------	--	--	--	--	--	--

<b>G24017</b>	-	<b>K5B</b>	<b>E</b>	<b>R</b>	<b>TR</b>					
---------------	---	------------	----------	----------	-----------	--	--	--	--	--

<b>K5B=</b> Material	<b>E=</b> Epoxy	<b>R=</b> ROHS conform	<b>TR=</b> Tray Packing			
	<b>P=</b> Parylene					

<b>Ring Cores</b>
Part No.: <b>G24017</b>
Customer:

DRW:	Jason	CHKD	Wilson	MATL:	Wilson	TOLERANCE	Mason	DATE	24.08.2012
APPD:	Schumi			FINISH	Jamy		Sheet No.		2 from 2