

EDCON-COMPONENTS

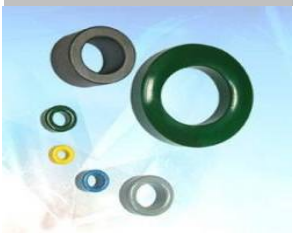

Description

Ring Core are mainly used for coupling transformers balancing coils, fixed coils and filter coils

Dimensions (mm)

Impedance curve

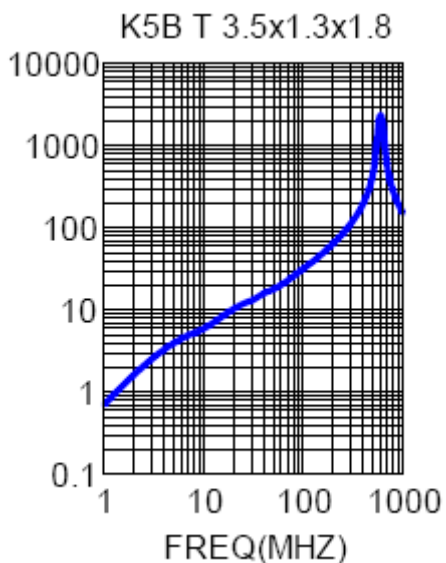

In the moment not available

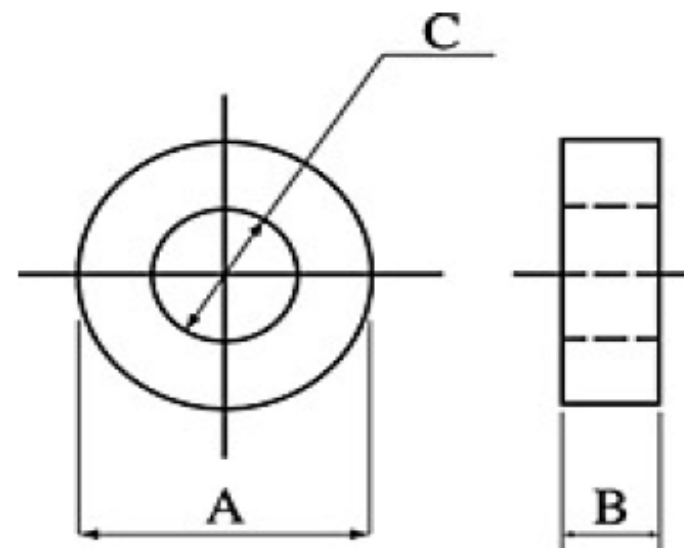

A= 3,50 ± 0,15
 B= 1,30 ± 0,20
 C= 1,80 ± 0,15
 Unit: mm

Other Sizes are available on request

Material K5B

Material A6

Ring Cores

Part No.: **G24004**

Customer:

DRW:	Jason	CHKD	Wilson	MATL:	Wilson	TOLERANCE	Mason	DATE	24.08.2012
APPD:	Schumi			FINISH	Jamy		Sheet No.	1 from 2	

www.edcon-components.com

email: info@edcon-components.com

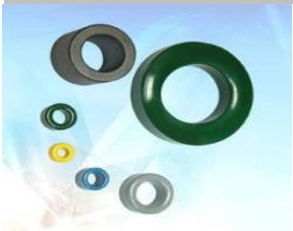

Ordering Informations

Serie	Material	Coating	ROHS	Packing						
-------	----------	---------	------	---------	--	--	--	--	--	--

G24004	-	K5B	E	R	TR					
---------------	---	------------	----------	----------	-----------	--	--	--	--	--

K5B= Material	E= Epoxy	R= ROHS conform	TR= Tray Packing			
	P= Parylene					

Ring Cores
Part No.: G24004
Customer:

DRW:	Jason	CHKD	Wilson	MATL:	Wilson	TOLERANCE	Mason	DATE	24.08.2012
APPD:	Schumi			FINISH	Jamy			Sheet No.	2 from 2