

EDCON-COMPONENTS

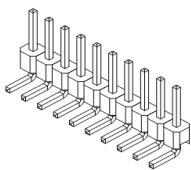

Contact



Specifications

Current Rating:	3 Ampere
Insulator Resistance:	5000 Megaohm min.
Dielectric Withstanding:	AC 1000V
Operating Temperature:	-.40°C to +105°C
Contact Material:	Copper, Alloy
Insulator Material:	Polyester, UL 94V-0
Standard:	P.B.T. other by order
Contact Plating:	Tin, Gold or Selective Plated
Standard:	Gold Flash Overall
Selectiv Plating:	Gold flash plated on contact area / tin plated on solder area

P.C.B Layout

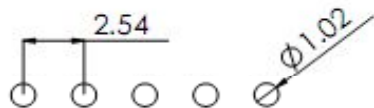

Drawing (dimensions all into mm)

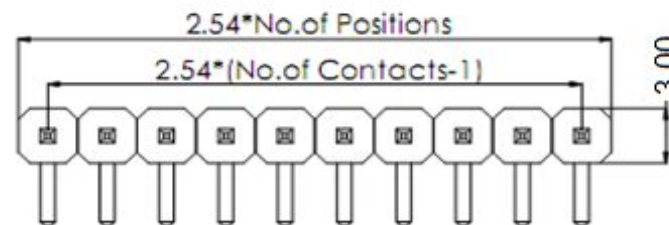
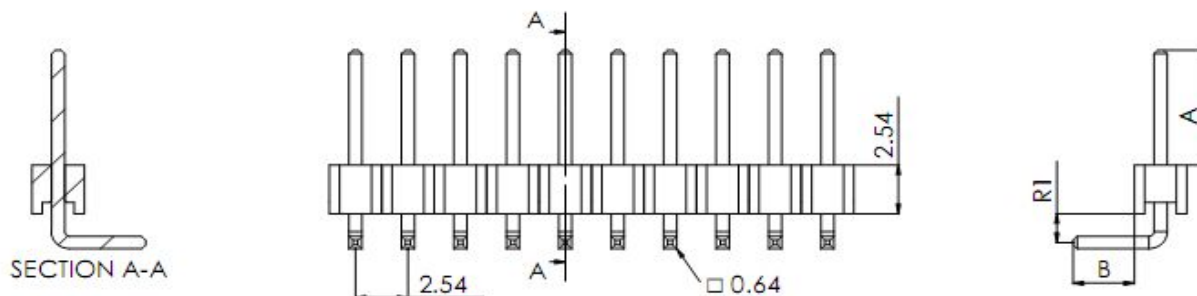

Tolerances unless otherwise specified (mm)				
X=	X.X=	X.XX=	X.XXX=	Angle=
±0,35	±0,25	±0,20	±0,15	±5°
DRW:	Jason	CHKD	Wilson	MATL:
APPD:	Schumi		FINISH	Jamy
			Sheet No.	1 from 4

PIN Header / Single Row / Single Body / Pitch 2,54mm

Part No.: **T51A1157-**

Customer:

EDCON-COMPONENTS

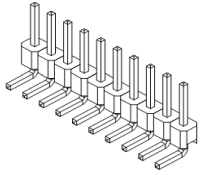

Contact



Pin Code length table free configuration

Order Code	Dimension (mm)		
	A	B	R1
A01	6,00	3,00	1,50
A02	5,80	13,10	1,50
A03	3,50	3,00	1,50
A04	6,70	3,20	1,50
A05	6,90	3,30	1,50
A06	15,20	3,80	1,50
A07	13,73	3,30	1,27
A08	9,96	3,30	1,27
A09	4,20	3,00	1,50
A10	5,80	2,29	1,30
A11	10,00	3,20	1,50
A12	3,52	3,34	1,27
A13	6,00	3,00	1,27
A14	7,00	3,00	1,27
A15	13,80	3,00	1,36
A16	5,70	2,90	1,10
A17	5,96	3,00	1,27
A18	18,00	10,00	1,50
A19	3,50	3,50	1,36
A20	9,94	3,30	1,40
A21	8,50	3,00	1,36
A22	2,40	2,40	1,36
A23	3,20	2,40	1,36
A24	6,30	2,40	1,36
A25	4,20	2,40	1,36
A26	16,00	3,00	1,50
A27	2,40	2,40	2,62
A28	10,00	3,20	0,90
A29	7,00	3,30	1,40

Order Code	Dimension (mm)		
	A	B	R1
A30	3,00	3,30	1,50
A31	4,00	3,30	1,50
A32	4,50	3,30	1,50
A33	5,00	3,30	1,50
A34	5,50	3,30	1,50
A35	6,50	3,30	1,50
A36	7,00	3,30	1,50
A37	7,50	3,30	1,50
A38	8,00	3,30	1,50
A39	8,50	3,30	1,50
A40	9,50	3,30	1,50
A41	10,50	3,30	1,50
A42	11,00	3,30	1,50
A43	11,50	3,30	1,50
A44	12,00	3,30	1,50
A45	3,00	2,50	1,50
A46	3,50	2,50	1,50
A47	4,00	2,50	1,50
A48	4,50	2,50	1,50
A49	5,00	2,50	1,50
A50	5,50	2,50	1,50
A51	6,00	2,50	1,50
A52	6,50	2,50	1,50
A53	7,00	2,50	1,50
A54	7,50	2,50	1,50
A55	8,00	2,50	1,50
A56	8,50	2,50	1,50
A57	9,00	2,50	1,50
A58	9,50	2,50	1,50

Order Code	Dimension (mm)		
	A	B	R1
A59	10,00	2,50	1,50
A60	10,50	2,50	1,50
A61	11,00	2,50	1,50
A62	11,50	2,50	1,50
A63	12,00	2,50	1,50
A64	12,50	2,50	1,50
A65	13,00	2,50	1,50
A66	13,50	2,50	1,50
A67	14,00	2,50	1,50
A68	3,00	2,00	1,50
A69	3,50	2,00	1,50
A70	4,00	2,00	1,50
A71	4,50	2,00	1,50
A72	5,00	2,00	1,50
A73	5,50	2,00	1,50
A74	6,00	2,00	1,50
A75	6,50	2,00	1,50
A76	7,00	2,00	1,50
A77	7,50	2,00	1,50
A78	8,00	2,00	1,50
A79	8,50	2,00	1,50
A80	9,00	2,00	1,50
A81	9,50	2,00	1,50
A82	10,00	2,00	1,50
A83	10,50	2,00	1,50
A84	11,00	2,00	1,50
A85	11,50	2,00	1,50
A86	12,00	2,00	1,50
A87	12,50	2,00	1,50

Order Code	Dimension (mm)		
	A	B	R1
A88	13,00	2,00	1,50
A89	13,50	2,00	1,50
A90	14,00	2,00	1,50
A91	10,00	3,20	3,83
A92	3,30	3,00	1,50
A93	2,20	3,00	1,50
A94	5,84	3,00	1,52
A95			
A96			
A97			
A98			
A99			
B01			
B02			
B03			
B04			
B05			
B06			
B07			
B08			
B09			
B10			
B11			
B12			
B13			
B14			
B15			
B16			
B17			

Order Code	Dimension (mm)		
	A	B	R1
B18			
B19			
B20			
B21			
B22			
B23			
B24			
B25			
B26			
B27			
B28			
B29			
B30			
B31			
B32			
B33			
B34			
B35			
B36			
B37			
B38			
B39			
B40			
B41			

PIN Header / Single Row / Single Body / Pitch 2,54mm

Part No.: **T51A1157-**
Customer:

DRW: Jason
APPD: Schumi

CHKD: Wilson
FINISH:

MATL: Wilson
TOLERANCE: Jamy

Mason
DATE: 16.06.2023
Sheet No.: 2 from 4

EDCON-COMPONENTS

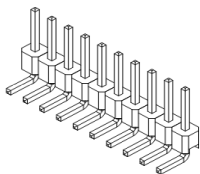

Contact



Ordering Informations

Serie	No. of Pos.	Construction	Contact Plating	Material	Polarisation Peg	Pin Length Code	ROHS	Packing		
T51A1157-	XX	RT	G0	PB	N	A01	R	BU		

XX = total pin of header	RT = right angle THT	G0 = Gold Flash (Standard)	PB =P.B.T (Standard)	N = No	look table page 2	N =NO ROHS	BU = Bulk (Standard)
		TN = Tin Plated	PY = Polyester UL94V-0			R =ROHS conform	TU = Tube w/o Cap
		GA = 10µ Gold Plating	NY = Nylon-6T				TC = Tube w. pic and Place Cap
		GB = 15µ Gold Plating					TY = Tray packing w/o Cap
		GC = 20µ Gold Plating					TR = Tape/Reel w. pic and Place Cap
		S0 = Selectiv Plating Gold Flash / Tin					TM = Tape/Reel w. pic and Place Mylar Foil (Foil Dimension look Description)

PIN Header / Single Row / Single Body / Pitch 2,54mm

Part No.: **T51A1157-**

Customer:

DRW:	Jason	CHKD	Wilson	MATL:	Wilson	TOLERANCE	Mason	DATE	16.06.2023
APPD:	Schumi			FINISH	Jamy		Sheet No.		3 from 4

www.edcon-components.com

email: info@edcon-components.com

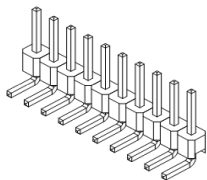

Contact



Soldering Profile for Lead Soldering (P.B.T.)

Soldering Profile for Lead Free Soldering (Nylon 6T)

Classification Reflow Profile (JEDEC J-STD-020C)

Classification Reflow Profile (JEDEC J-STD-020C)

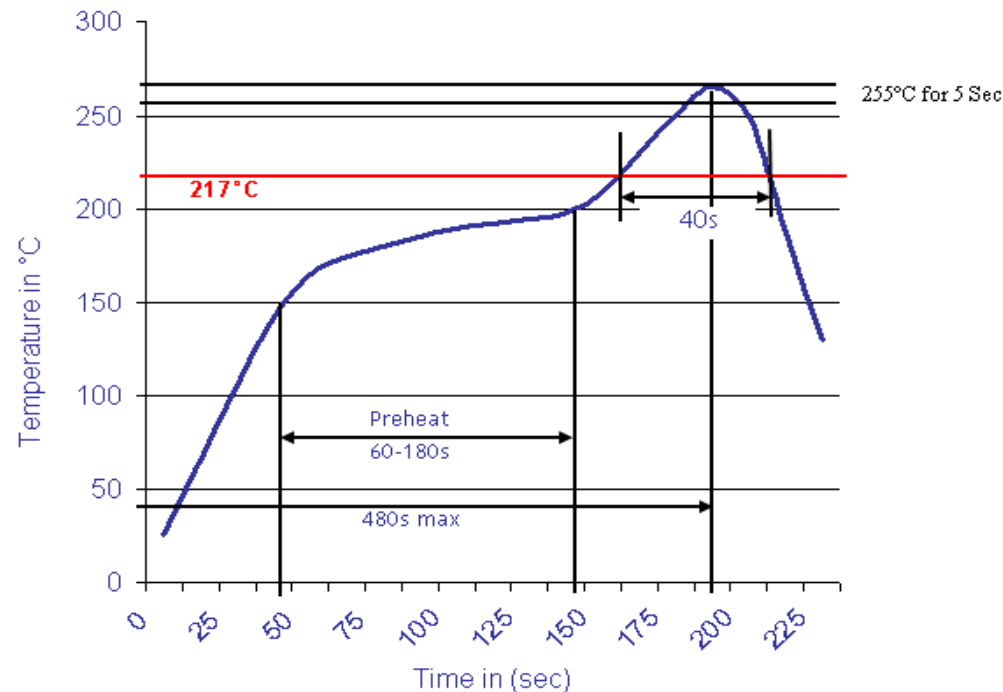
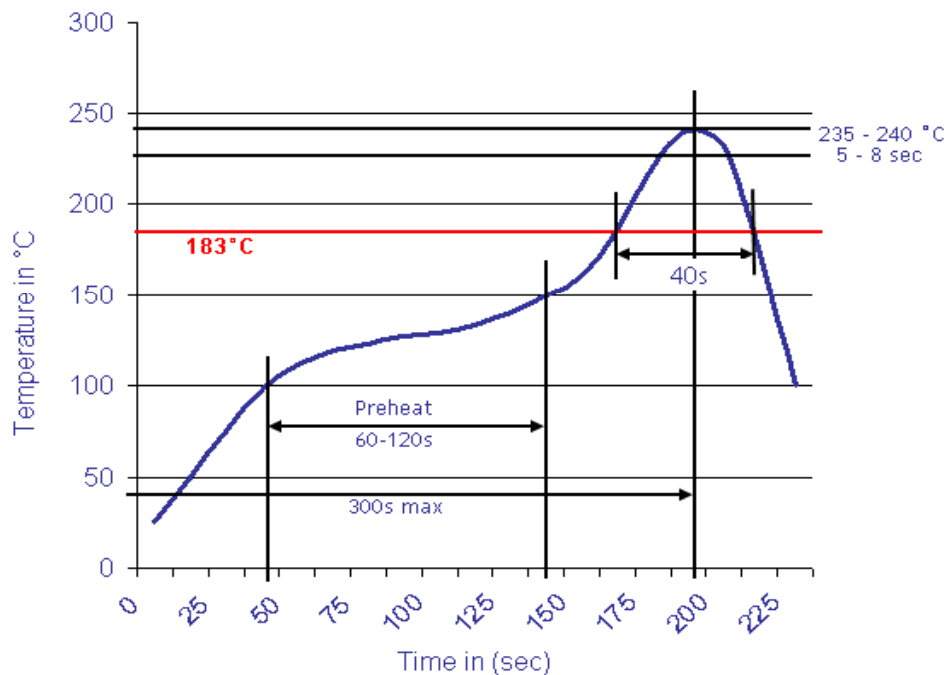

PIN Header / Single Row / Single Body / Pitch 2,54mm

Part No.: **T51A1157-**

Customer:

DRW:	Jason	CHKD	Wilson	MATL:	Wilson	TOLERANCE	Mason	DATE	16.06.2023
APPD:	Schumi			FINISH	Jamy		Sheet No.		4 from 4