

EDCON-COMPONENTS

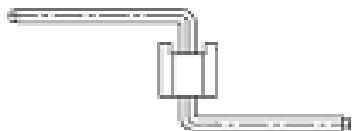

Specifications

Current Rating:	3 Ampere
Insulator Resistance:	5000 Megaohm min.
Dielectric Withstanding:	AC 1000V
Operating Temperature:	-40°C to +105°C
Contact Material:	Copper, Alloy
Insulator Material:	Polyester, UL 94V-0
Standard:	P.B.T.
Contact Plating:	Tin, Gold or Selective Plated
Standard:	Gold Flash Overall
Selectiv Plating:	Gold flash plated on contact area / tin plated on solder area

Drawing (dimensions all into mm)

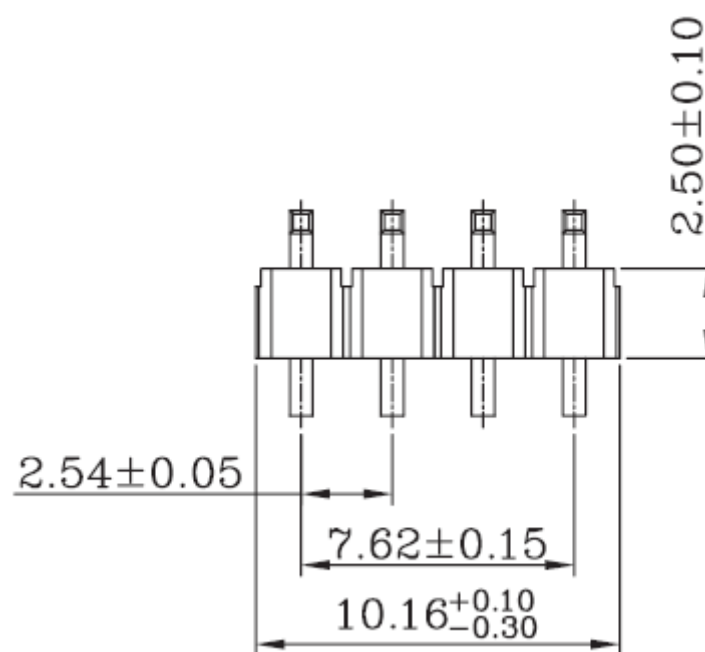
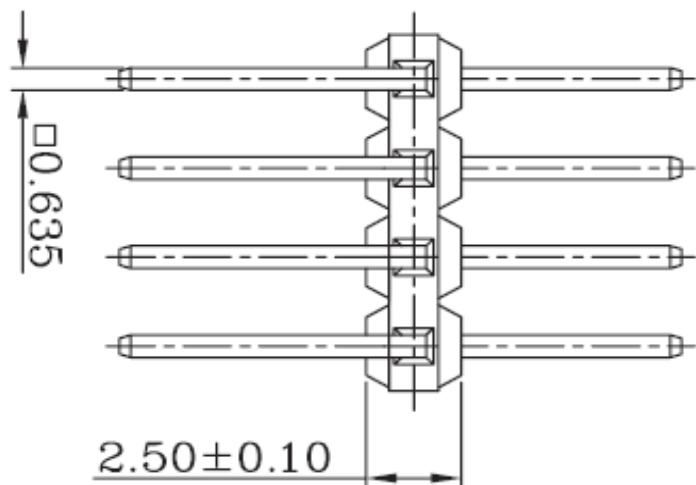

PIN Header / Single Row / Single
Body / Pitch 2,54mm

Part No.: **T51A1062-**

Customer:

DRW:	Jason	CHKD	Wilson	MATL:	Wilson	TOLERANCE	Mason	DATE	24.02.2015
APPD:	Schumi			FINISH	Jamy		Sheet No.	1 from 3	

EDCON-COMPONENTS

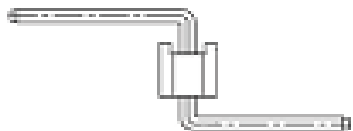

Pin Code length table free configuration

Order Code	Dimension (mm)			
	A	B	C	D
A01	14,80	5,80	3,80	5,10
A02				
A03				
A04				
A05				
A06				
A07				
A08				
A09				
A10				
A11				
A12				
A13				
A14				
A15				
A16				
A17				
A18				
A19				
A20				
A21				
A22				

Order Code	Dimension (mm)			
	A	B	C	D
A23				
A24				
A25				
A26				
A27				
A28				
A29				
A30				
A31				
A32				
A33				
A34				
A35				
A36				
A37				
A38				
A39				
A40				
A41				
A42				
A43				
A44				

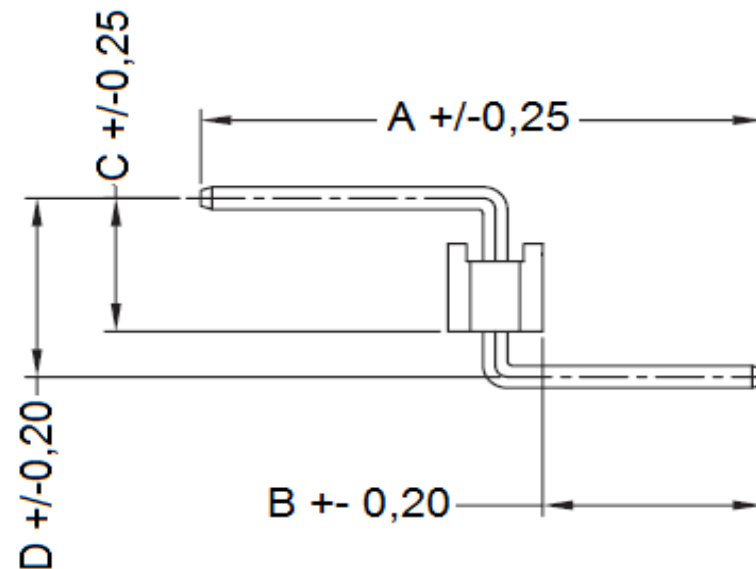

PIN Header / Single Row / Single Body / Pitch 2,54mm

Part No.: **T51A1062-**

Customer:

DRW:	Jason	CHKD	Wilson	MATL:	Wilson	TOLERANCE	Mason	DATE	24.02.2015
APPD:	Schumi			FINISH	Jamy		Sheet No.	2 from 3	

EDCON-COMPONENTS

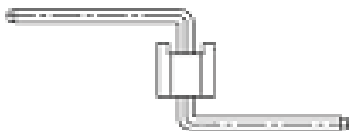

Ordering Informations

Serie	No. of Pos.	Construction	Contact Plating	Material	Polarisation Peg	Pin Length Code	ROHS	Packing		
T51A1062-	XX	RT	G0	PB	N	A01	R	BU		

XX= total pin of header	RT= right angle THT	G0= Gold Flash (Standard)	PB= P.B.T (Standard)	N= No	look table page 2	N= NO ROHS conform	BU= Bulk (Standard)
		T0= Tin plated	PY= Polyester UL94V-0			R= ROHS conform	
		GA= 10µ Gold Plating	NY= Nylon-6T				
		GB= 15µ Gold Plating					
		GC= 20µ Gold Plating					
		S0= Selectiv Plating Gold Flash / Tin					
		TN= Tin Plated					

PIN Header / Single Row / Single Body / Pitch 2,54mm

Part No.: **T51A1062-**

DRW:	Jason	CHKD	Wilson	MATL:	Wilson	TOLERANCE	Mason	DATE	24.02.2015
APPD:	Schumi			FINISH	Jamy		Sheet No.		3 from 3

Customer: