

# EDCON-COMPONENTS

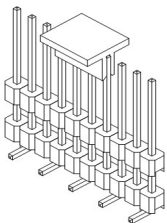

## Specifications

|                          |                                                                  |
|--------------------------|------------------------------------------------------------------|
| Current Rating:          | 3 Ampere                                                         |
| Insulator Resistance:    | 5000 Megaohm min.                                                |
| Dielectric Withstanding: | AC 1000V                                                         |
| Operating Temperature:   | -.40°C to +105°C                                                 |
| Contact Material:        | Copper, Alloy                                                    |
| Insulator Material:      | Polyester, UL 94V-0                                              |
| Standard:                | P.B.T.                                                           |
| Contact Plating:         | Tin, Gold or Selective Plated                                    |
| Standard:                | Gold Flash Overall                                               |
| Selectiv Plating:        | Gold flash plated on contact area /<br>tin plated on solder area |
| Max. Processing Temp.    | 230°C for 60 seconds                                             |

## Drawing ( dimensions all into mm )

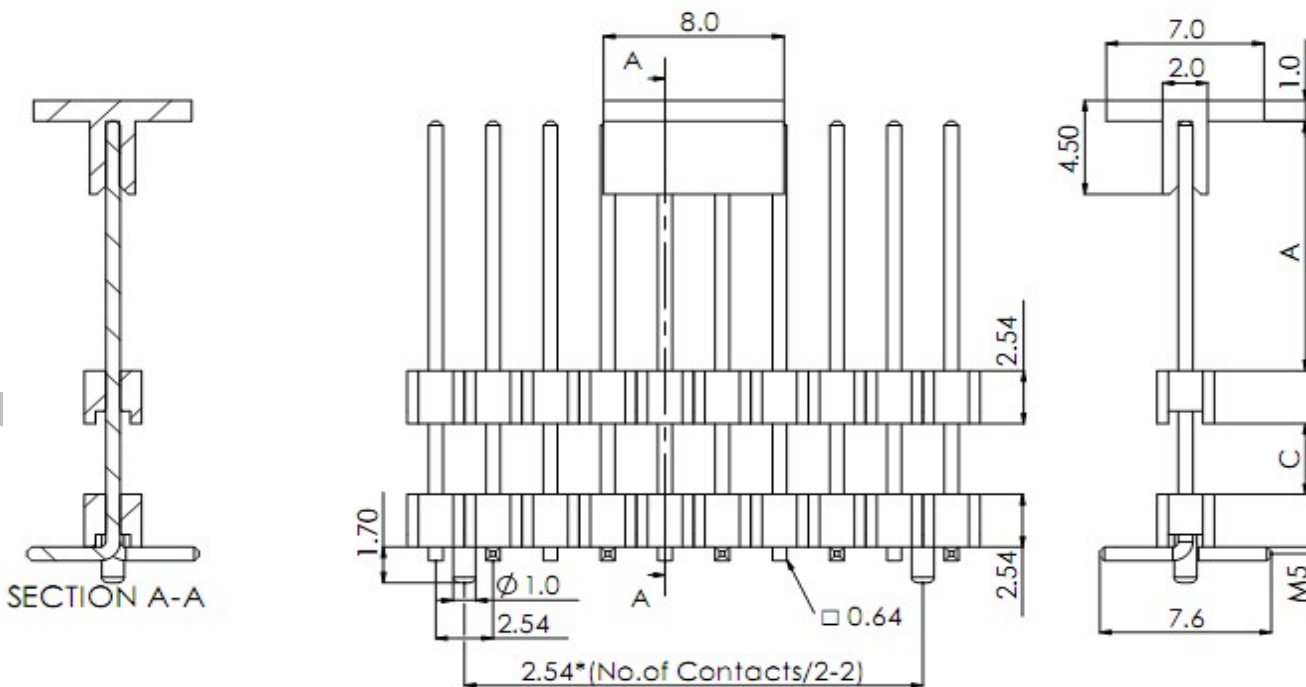

## P.C.B Layout

### Layout Type SSA

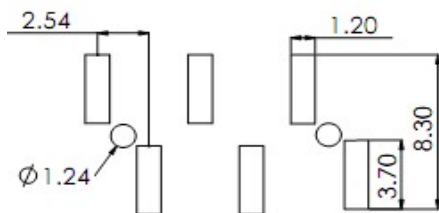

### Layout Type SSB

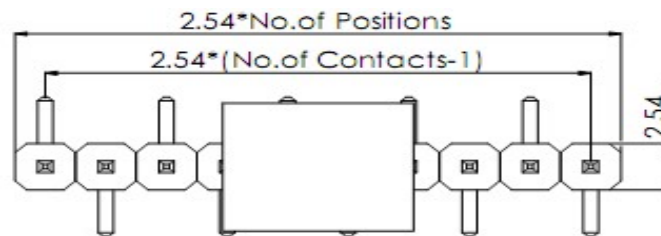
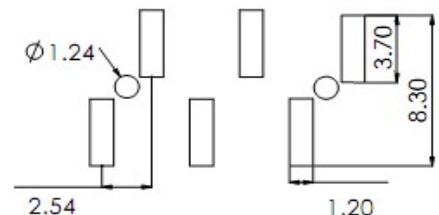

PIN Header / Single Row / Dual Body / Pitch 2,54mm  
Part No.: **T51A1044 -**

|       |        |      |        |        |        |           |           |      |            |
|-------|--------|------|--------|--------|--------|-----------|-----------|------|------------|
| DRW:  | Jason  | CHKD | Wilson | MATL:  | Wilson | TOLERANCE | Mason     | DATE | 14.05.2023 |
| APPD: | Schumi |      |        | FINISH | Jamy   |           | Sheet No. |      | 1 from 4   |

[www.edcon-components.com](http://www.edcon-components.com)

email: [info@edcon-components.com](mailto:info@edcon-components.com)

# EDCON-COMPONENTS

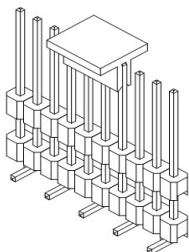

**Pin Code length table free configuration off mm**

| Order | Dimension (mm) |      |      |       |
|-------|----------------|------|------|-------|
| Code  | A              | C    | M5   | TH    |
| A01   | 12,00          | 3,40 | 0,32 | 21,12 |
| A02   | 5,70           | 8,28 | 0,32 | 19,70 |
| A03   | 4,00           | 3,40 | 0,32 | 13,12 |
| A04   | 4,50           | 3,40 | 0,32 | 13,62 |
| A05   | 5,00           | 3,40 | 0,32 | 14,12 |
| A06   | 5,50           | 3,40 | 0,32 | 14,62 |
| A07   | 6,00           | 3,40 | 0,32 | 15,12 |
| A08   | 6,50           | 3,40 | 0,32 | 15,62 |
| A09   | 7,00           | 3,40 | 0,32 | 16,12 |
| A10   | 7,50           | 3,40 | 0,32 | 16,62 |
| A11   | 8,00           | 3,40 | 0,32 | 17,12 |
| A12   | 8,50           | 3,40 | 0,32 | 17,62 |
| A13   | 9,00           | 3,40 | 0,32 | 18,12 |
| A14   | 9,50           | 3,40 | 0,32 | 18,62 |
| A15   | 10,00          | 3,40 | 0,32 | 19,12 |
| A16   | 10,50          | 3,40 | 0,32 | 19,62 |
| A17   | 11,00          | 3,40 | 0,32 | 20,12 |
| A18   | 11,50          | 3,40 | 0,32 | 20,62 |
| A19   | 6,00           | 4,00 | 0,32 | 15,72 |
| A20   | 6,00           | 4,50 | 0,32 | 16,22 |
| A21   | 6,00           | 5,00 | 0,32 | 16,72 |
| A22   | 6,00           | 5,50 | 0,32 | 17,22 |
| A23   | 6,00           | 6,00 | 0,32 | 17,72 |
| A24   | 6,00           | 6,50 | 0,32 | 18,22 |
| A25   | 6,00           | 7,00 | 0,32 | 18,72 |
| A26   | 6,00           | 7,50 | 0,32 | 19,22 |

| Order | Dimension (mm) |       |      |       |
|-------|----------------|-------|------|-------|
| Code  | A              | C     | M5   | TH    |
| A27   | 6,00           | 8,00  | 0,32 | 19,72 |
| A28   | 6,00           | 8,50  | 0,32 | 20,22 |
| A29   | 6,00           | 9,00  | 0,32 | 20,72 |
| A30   | 6,00           | 9,50  | 0,32 | 21,22 |
| A31   | 6,00           | 10,00 | 0,32 | 21,72 |
| A32   | 6,00           | 10,50 | 0,32 | 22,22 |
| A33   | 6,00           | 11,00 | 0,32 | 22,72 |
| A34   | 6,00           | 11,50 | 0,32 | 23,22 |
| A35   | 6,00           | 12,00 | 0,32 | 23,72 |
| A36   | 6,00           | 12,50 | 0,32 | 24,22 |
| A37   | 6,00           | 13,00 | 0,32 | 24,72 |
| A38   | 6,00           | 13,50 | 0,32 | 25,22 |
| A39   | 6,00           | 14,00 | 0,32 | 25,72 |
| A40   | 6,00           | 14,50 | 0,32 | 26,22 |
| A41   | 6,00           | 15,00 | 0,32 | 26,72 |
| A42   | 6,00           | 15,50 | 0,32 | 27,22 |
| A43   | 6,00           | 16,00 | 0,32 | 27,72 |
| A44   | 6,00           | 16,50 | 0,32 | 28,22 |
| A45   | 6,00           | 17,00 | 0,32 | 28,72 |
| A46   | 6,00           | 17,50 | 0,32 | 29,22 |
| A47   | 6,00           | 18,00 | 0,32 | 29,72 |
| A48   | 6,00           | 18,50 | 0,32 | 30,22 |
| A49   | 6,00           | 19,00 | 0,32 | 30,72 |
| A50   | 6,00           | 19,50 | 0,32 | 31,22 |
| A51   | 6,00           | 20,00 | 0,32 | 31,72 |
| A52   | 12,00          | 4,00  | 0,32 | 21,72 |

| Order | Dimension (mm) |       |      |       |
|-------|----------------|-------|------|-------|
| Code  | A              | C     | M5   | TH    |
| A53   | 12,00          | 4,50  | 0,32 | 22,22 |
| A54   | 12,00          | 5,00  | 0,32 | 22,72 |
| A55   | 12,00          | 5,50  | 0,32 | 23,22 |
| A56   | 12,00          | 6,00  | 0,32 | 23,72 |
| A57   | 12,00          | 6,50  | 0,32 | 24,22 |
| A58   | 12,00          | 7,00  | 0,32 | 24,72 |
| A59   | 12,00          | 7,50  | 0,32 | 25,22 |
| A60   | 12,00          | 8,00  | 0,32 | 25,72 |
| A61   | 12,00          | 8,50  | 0,32 | 26,22 |
| A62   | 12,00          | 9,00  | 0,32 | 26,72 |
| A63   | 12,00          | 9,50  | 0,32 | 27,22 |
| A64   | 12,00          | 10,00 | 0,32 | 27,72 |
| A65   | 12,00          | 10,50 | 0,32 | 28,22 |
| A66   | 12,00          | 11,00 | 0,32 | 28,72 |
| A67   | 12,00          | 11,50 | 0,32 | 29,22 |
| A68   | 12,00          | 12,00 | 0,32 | 29,72 |
| A69   | 12,00          | 12,50 | 0,32 | 30,22 |
| A70   | 4,00           | 4,00  | 0,32 | 13,72 |
| A71   | 4,00           | 4,50  | 0,32 | 14,22 |
| A72   | 4,00           | 5,00  | 0,32 | 14,72 |
| A73   | 4,00           | 5,50  | 0,32 | 15,22 |
| A74   | 4,00           | 6,00  | 0,32 | 15,72 |
| A75   | 4,00           | 6,50  | 0,32 | 16,22 |
| A76   | 4,00           | 7,00  | 0,32 | 16,72 |
| A77   | 4,00           | 7,50  | 0,32 | 17,22 |
| A78   | 4,00           | 8,00  | 0,32 | 17,72 |

| Order | Dimension (mm) |       |      |       |
|-------|----------------|-------|------|-------|
| Code  | A              | C     | M5   | TH    |
| A79   | 4,00           | 8,50  | 0,32 | 18,22 |
| A80   | 4,00           | 9,00  | 0,32 | 18,72 |
| A81   | 4,00           | 9,50  | 0,32 | 19,22 |
| A82   | 4,00           | 10,00 | 0,32 | 19,72 |
| A83   | 4,00           | 10,50 | 0,32 | 20,22 |
| A84   | 4,00           | 11,00 | 0,32 | 20,72 |
| A85   | 4,00           | 11,50 | 0,32 | 21,22 |
| A86   | 4,00           | 12,00 | 0,32 | 21,72 |
| A87   | 4,00           | 12,50 | 0,32 | 22,22 |
| A88   | 4,00           | 13,00 | 0,32 | 22,72 |
| A89   | 4,00           | 13,50 | 0,32 | 23,22 |
| A90   | 4,00           | 14,00 | 0,32 | 23,72 |
| A91   | 4,00           | 14,50 | 0,32 | 24,22 |
| A92   | 4,00           | 15,00 | 0,32 | 24,72 |
| A93   | 4,00           | 15,50 | 0,32 | 25,22 |
| A94   | 4,00           | 16,00 | 0,32 | 25,72 |
| A95   | 4,00           | 16,50 | 0,32 | 26,22 |
| A96   | 4,00           | 17,00 | 0,32 | 26,72 |
| A97   | 4,00           | 17,50 | 0,32 | 27,22 |
| A98   |                |       |      |       |
| A99   |                |       |      |       |
| B00   |                |       |      |       |
| B01   |                |       |      |       |

PIN Header / Single Row / Dual Body / Pitch 2,54mm

Part No.: **T51A1044 -**

Customer:

|       |        |      |        |        |        |           |           |      |            |
|-------|--------|------|--------|--------|--------|-----------|-----------|------|------------|
| DRW:  | Jason  | CHKD | Wilson | MATL:  | Wilson | TOLERANCE | Mason     | DATE | 14.05.2023 |
| APPD: | Schumi |      |        | FINISH | Jamy   |           | Sheet No. |      | 2 from 4   |

# EDCON-COMPONENTS

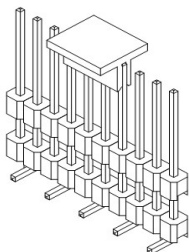

## Ordering Informations

| Serie             | No. of Pos. | Layout     | Contact Plating | Material  | Polarisation Peg | Pin Length Code | ROHS     | Packing   |  |  |
|-------------------|-------------|------------|-----------------|-----------|------------------|-----------------|----------|-----------|--|--|
| <b>T51A1044 -</b> | <b>XX</b>   | <b>SSA</b> | <b>G0</b>       | <b>PB</b> | <b>Y</b>         | <b>A01</b>      | <b>R</b> | <b>BU</b> |  |  |

|                                 |                                         |                                               |                             |                     |                   |                           |                                            |
|---------------------------------|-----------------------------------------|-----------------------------------------------|-----------------------------|---------------------|-------------------|---------------------------|--------------------------------------------|
| <b>XX</b> = total pin of header | <b>SSA</b> = straight SMT Layout Type A | <b>G0</b> = Gold Flash (Standard)             | <b>PB</b> =P.B.T (Standard) | <b>Y</b> = With Peg | look table page 2 | <b>N</b> =NO ROHS conform | <b>BU</b> = Bulk (Standard)                |
|                                 | <b>SSB</b> = straight SMT Layout Type B | <b>T0</b> = Tin plated                        |                             |                     |                   |                           |                                            |
|                                 |                                         | <b>GA</b> = 10µ Gold Plating                  | <b>NY</b> = Nylon-6T        |                     |                   |                           | <b>TC</b> = Tube w. pic and Place Cap      |
|                                 |                                         | <b>GB</b> = 15µ Gold Plating                  |                             |                     |                   |                           | <b>TY</b> = Tray packing w/o Cap           |
|                                 |                                         | <b>GC</b> = 20µ Gold Plating                  |                             |                     |                   |                           | <b>TR</b> = Tape/Reel w. pic and Place Cap |
|                                 |                                         | <b>S0</b> = Selectiv Plating Gold Flash / Tin |                             |                     |                   |                           |                                            |
|                                 |                                         | <b>TN</b> = Tin Plated                        |                             |                     |                   |                           |                                            |

|                                                    |
|----------------------------------------------------|
| PIN Header / Single Row / Dual Body / Pitch 2,54mm |
| Part No.: <b>T51A1044 -</b>                        |
| Customer:                                          |

|       |        |      |        |        |        |           |           |      |            |
|-------|--------|------|--------|--------|--------|-----------|-----------|------|------------|
| DRW:  | Jason  | CHKD | Wilson | MATL:  | Wilson | TOLERANCE | Mason     | DATE | 14.05.2023 |
| APPD: | Schumi |      |        | FINISH | Jamy   |           | Sheet No. |      | 3 from 4   |

[www.edcon-components.com](http://www.edcon-components.com)

email: [info@edcon-components.com](mailto:info@edcon-components.com)

# EDCON-COMPONENTS

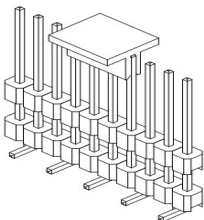

## Soldering Profile for Lead Soldering ( P.B.T. )

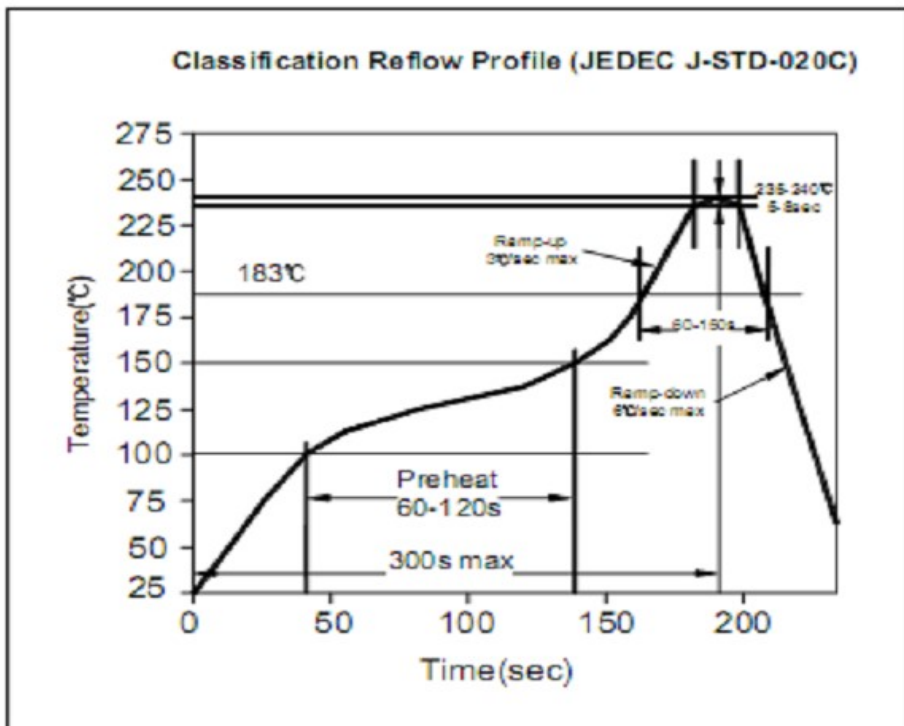

## Soldering Profile for Lead Free Soldering ( Nylon 6T )

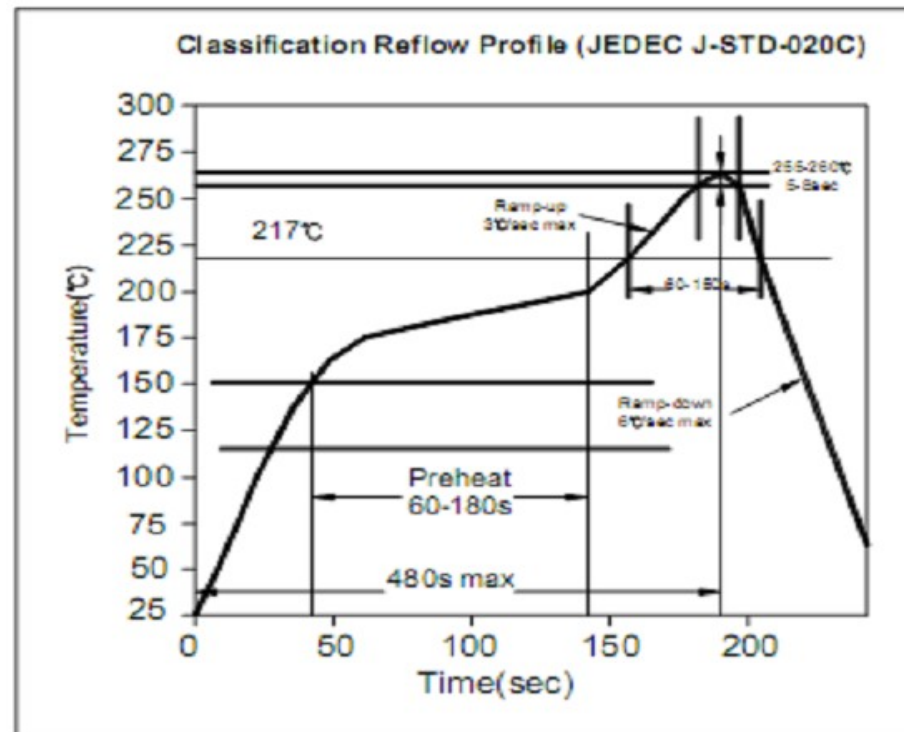

PIN Header / Single Row / Dual Body / Pitch 2,54mm

Part No.: **T51A1044 -**

|       |        |      |        |        |        |           |           |          |            |           |
|-------|--------|------|--------|--------|--------|-----------|-----------|----------|------------|-----------|
| DRW:  | Jason  | CHKD | Wilson | MATL:  | Wilson | TOLERANCE | Mason     | DATE     | 14.05.2023 | Customer: |
| APPD: | Schumi |      |        | FINISH | Jamy   |           | Sheet No. | 4 from 4 |            |           |

[www.edcon-components.com](http://www.edcon-components.com)

email: [info@edcon-components.com](mailto:info@edcon-components.com)