

EDCON-COMPONENTS

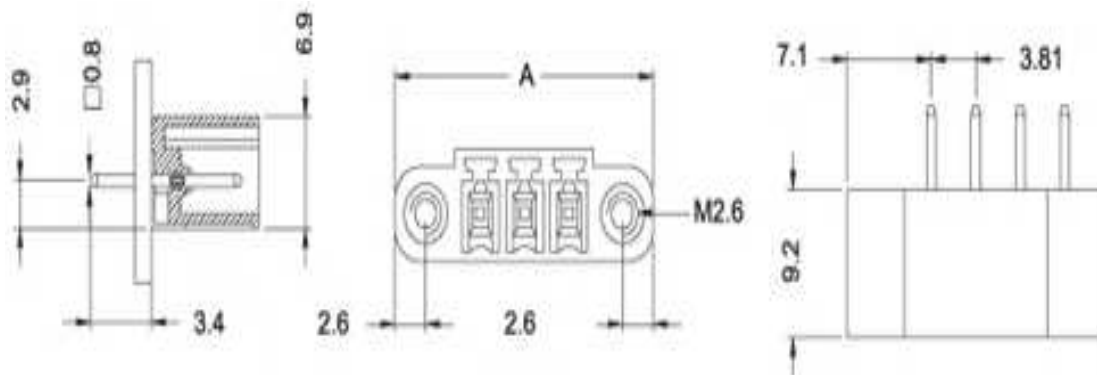

Drawing



P.C.B. Layout

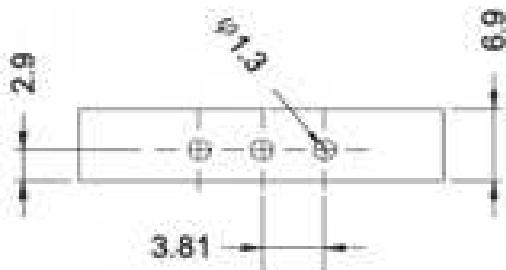

	A[mm]	A[mm]	A[mm]
02P	18.0	14P	63.7
03P	21.8	15P	67.6
04P	25.6	16P	71.4
05P	29.5	17P	75.2
06P	33.3	18P	79.0
07P	37.1	19P	82.8
08P	40.9	20P	86.6
09P	44.7	21P	90.4
10P	48.5	22P	94.2
11P	52.3	23P	98.0
12P	56.1	24P	101.8
13P	59.9		

Specification

APPROVAL

Electrical

Standard
Rated voltage
Rated current

Mechanical

Ambient temperature

Dimensions

Pitch
Poles

Material

Housing
Pin header



cUL AC 300V 12A	VDE AC 300V 10A
-----------------------	-----------------------

-40°C ~ +105°C

3.81mm
2P - 24P

PA66 (UL94V-0)
Brass, Tin plated



[Certification](#)



Pluggable Terminal Block /
Pitch 3.81mm

Part No.: A14H014

Customer:

DRW:	Justin	CHKD	Frank	MATL:	Jordan	TOLERANCE	Lord	Date	10.02.2009
APPD:	Pete			FINISH	Mike			Sheet No.	1 from 3

www.edcon-components.com

email: info@edcon-components.com

EDCON-COMPONENTS



Ordering Informations

Serie	-	No. of Pole	Body-Color	-	Customer Request
A14H014	-	XX	XX	-	X
		XX = total	WH - white		
		02	GN - green		
		...	GR - gray		
		24	TP - transparent		
			OR - orange		
			BK - black		
			BL - blue		
			RD - red		
			YW - yellow		
			PG - Phoenix Green		



Pluggable Terminal Block / Pitch 3.81 mm	
Part No.:	A14H014
Customer:	

DRW:	Justin	CHKD	Frank	MATL:	Jordan	TOLERANCE	Lord	Date	10.02.2009
APPD:	Pete			FINISH	Mike			Sheet No.	2 from 3

www.edcon-components.com

email: info@edcon-components.com



Soldering - Profil

Classification Reflow Profile (JEDEC J-STD-020C)

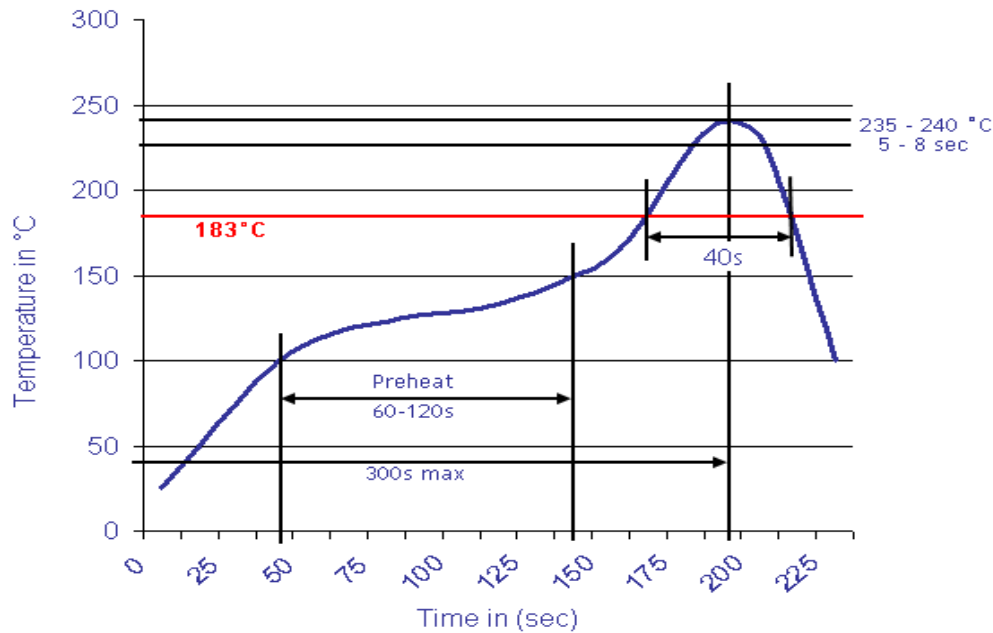

Pluggable Terminal Block / Pitch 3.81 mm	
Part No.:	A14H014
Customer:	

DRW:	Justin	CHKD	Frank	MATL:	Jordan	TOLERANCE	Lord	Date	10.02.2009
APPD:	Pete			FINISH	Mike			Sheet No.	3 from 3