

EDCON-COMPONENTS

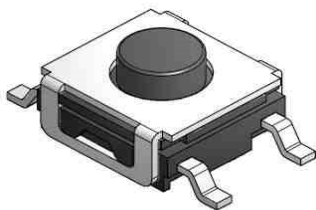

SPECIFICATION:

Current Rating:	DC12V / 50mA
Insulator Resistance:	100 Mega Ω min.
Contact Resistance:	100 m Ω max.
Travel:	0,25 / +/- 0,1mm
Operating Temperature:	-.40°C to +105°C
Lifetime:	look order code
Operating Force:	look order code

Common Specifications

Life Test	50/80 Cycles / Min with 5VDC 5mA Resistive load Cycles of Operation: As per individual Specifications
Dry Heat Proof	80°C +/- 2°C for 96hours after Test Kept in Normal Condition for 30Min.
Moisture Resistance	60°C +/- 2°C 90~95% RH for 96 Hours After Test, Kept in Normal Condition for 30 Minutes
Cold Proof	. 30°C for 96 Hours After Test Kept in Normal Condition for 30 Minutes.
Operating Force	If refers to the maximum load at the time of switching over of the contacts. (Point A in the figure)
Travel	This refers to the state of repeating the contact opening or closing momentarily at the time of the changeover of the switch to ON or OFF. Longer duration of this state

Drawing

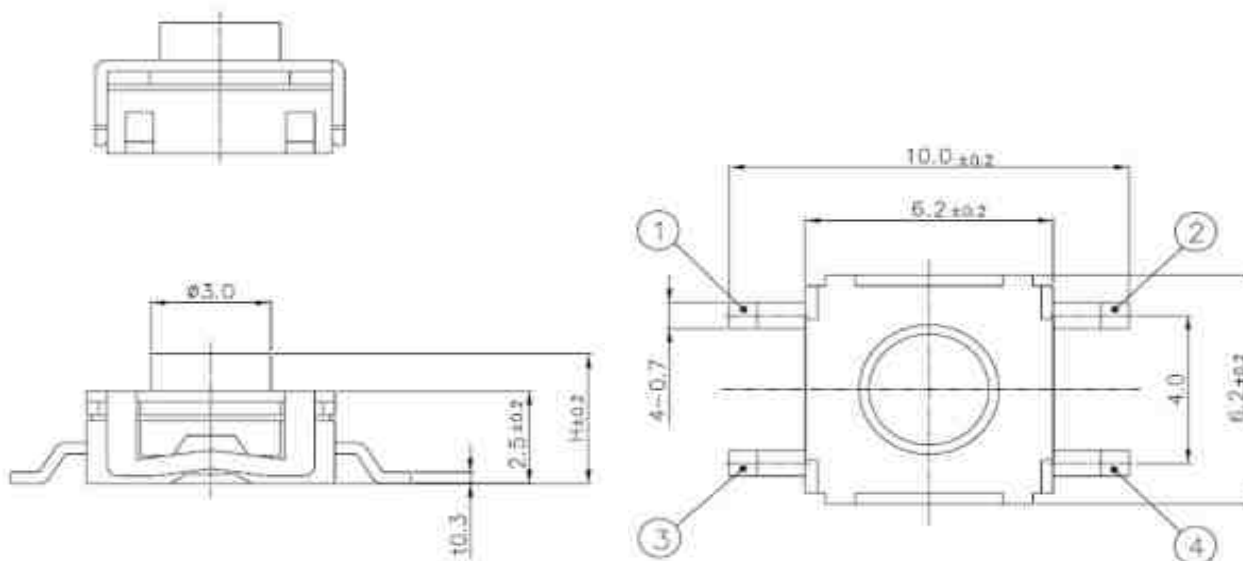

PCB Layout

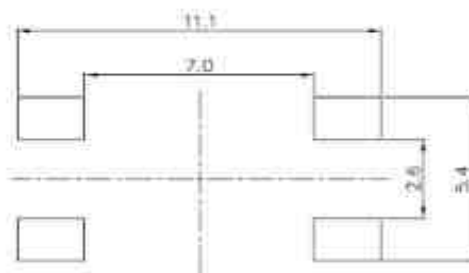

Circuit Diagram

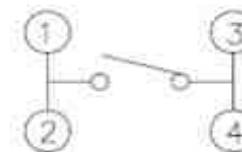

SMT TACT SWITCH
6,2x6,2mm

Part No.: **Q12047**

DRW:	Jason	CHKD	Wilson	MATL:	Wilson	TOLERANCE	Mason	DATE	08.08.2016
APPD:	Schumi			FINISH	Jamy		Sheet No.	1 from 3	Customer:

EDCON-COMPONENTS

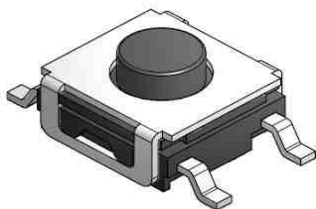

Ordering Informations

Serie	Total height	Function	Operating Force	Function	Electrical life	Function	ROHS	Packing		
Q12047	035	N	161	N	803	N	R	TU65		
	035= 3,5mm	N= No function	161 = 160gr	N= No function	803= 80000 cycles by 160gr. O-Force	N= No function	N= non ROHS	TU65= Tupe w. 65PCS		
	047= 4,7mm		201 = 200gr		803= 80000 cycles by 200gr. O-Force		R= ROHS conform	BU50= Bulk 500PCS		
	052= 5,2mm		301 = 300gr		503= 50000 cycles by 300gr. O-Force					
	025= 2,5mm									
	027= 2,7mm									
	031= 3,1mm									
	034= 3,4mm									
	038= 3,8mm									
	050= 5,0mm									

**SMT TACT SWITCH
6,2x6,2mm**

Part No.: **Q12047**

DRW:	Jason	CHKD	Wilson	MATL:	Wilson	TOLERANCE	Mason	DATE	08.08.2016
APPD:	Schumi			FINISH	Jamy		Sheet No.		2 from 3

Customer:

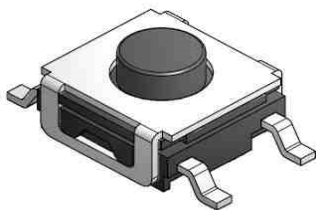

Soldering Profile for Lead Free Soldering

Classification Reflow Profile (JEDEC J-STD-020C)

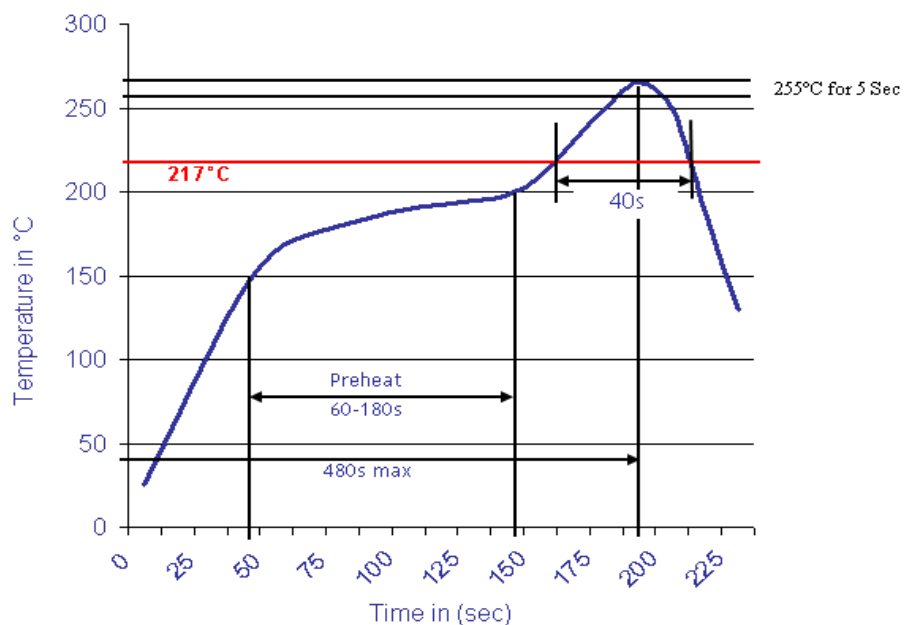

**SMT TACT SWITCH
6,2x6,2mm**

Part No.: **Q12047**

DRW:	Jason	CHKD	Wilson	MATL:	Wilson	TOLERANCE	Mason	DATE	08.08.2016
APPD:	Schumi			FINISH	Jamy		Sheet No.	3 from 3	Customer: