

# EDCON-COMPONENTS

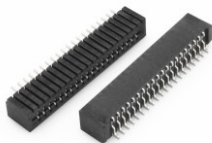

**Contact**



## Specifications

Material Housing	LCP Thermoplastic High Temp UL94V-0 Color Black
Terminal:	Copper Alloy
Fitting Nail:	Copper Alloy
Plating Finish:	Matt Tin
Fitting Nail:	Matt Tin overall
<b>Electrical:</b>	
Current Rating:	0,5A/AC/DC
Voltage Rating:	50V AC/DC
Temperature Range:	- 20°C ~ +85°C
Contact Resistance:	40m Ohm max.
Insulation Resistance:	800M Ohm min.
Withstanding Voltage:	250V AC/Minute
Relative Humidity:	70% max.
Number off Position	04 to 33Pos.

## Drawing

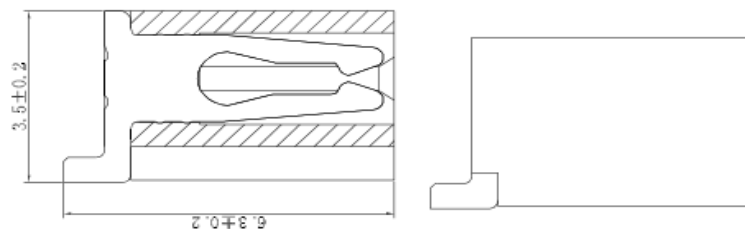
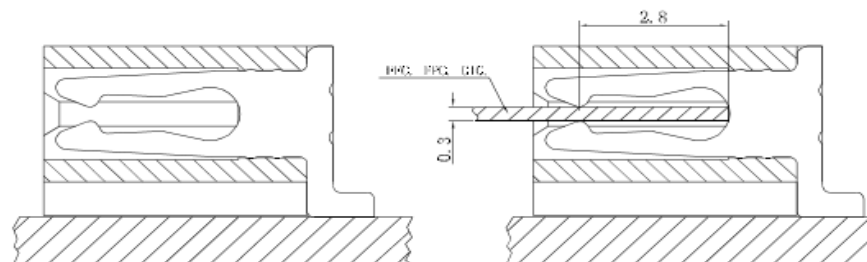
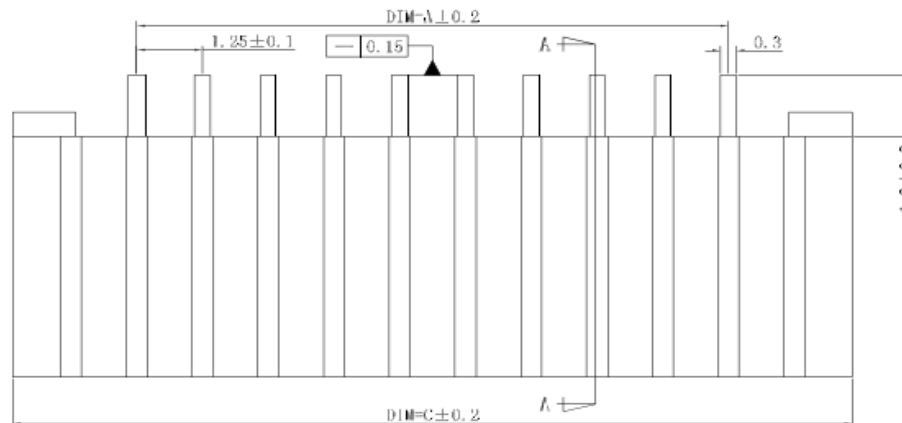

## P.C.B Layout

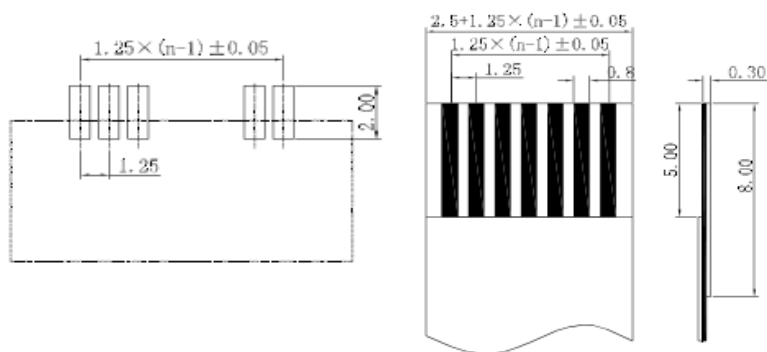

**FFC/FPC Connector Pitch  
1,25mm DUAL Contact**

Part No.: **T28E022**

Customer:

DRW:	Jason	CHKD	Wilson	MATL:	Wilson	TOLERANCE	Mason	DATE	07.07.2024
APPD:	Schumi			FINISH	Jamy		Sheet No.		1 from 2

# EDCON-COMPONENTS

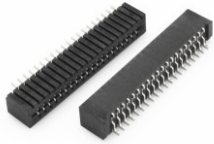

**Contact**



## Ordering Informations

Serie	No. of Pos.	Construction	Contact Plating	Material	Special function	Special function	ROHS	Packing		
<b>T28E022</b>	<b>xx</b>	<b>RS</b>	<b>T0</b>	<b>LC</b>	<b>0</b>	<b>0</b>	<b>R</b>	<b>TU</b>		

XX= total				0= No function	0= No function	N=NON ROHS conform	TU= Tube
		T0= Tin plated					
						R=ROHS conform	TR= Tape Reel Packing
	RS= Right angle SMT						
			LC= LCP, UL94V-0				

**FFC/FPC Connector Pitch  
1,25mm DUAL Contact**

Part No.: **T28E022**

Customer:

DRW:	Jason	CHKD	Wilson	MATL:	Wilson	TOLERANCE	Mason	DATE	07.07.2024
APPD:	Schumi			FINISH	Jamy		Sheet No.		2 from 3

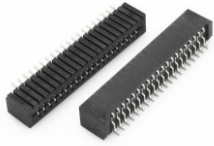

Contact



Lead Free Solder Curve

Classification Reflow Profile (JEDEC J-STD-020C)

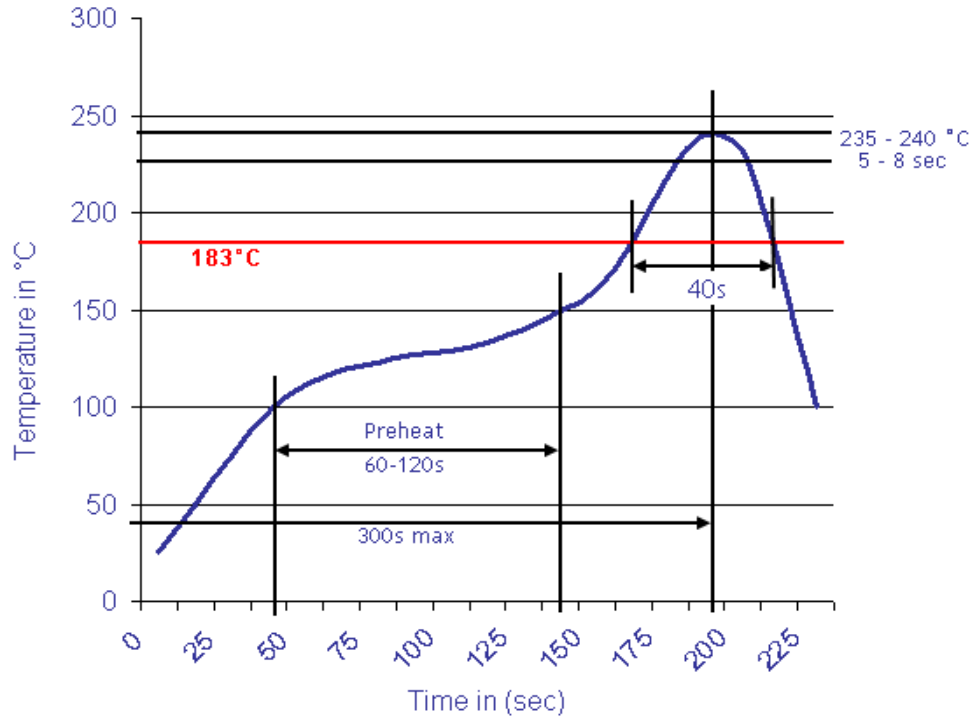

**FFC/FPC Connector Pitch  
1,25mm DUAL Contact**

Part No.: **T28E022**

DRW:	Jason	CHKD	Wilson	MATL:	Wilson	TOLERANCE	Mason	DATE	07.07.2024
APPD:	Schumi			FINISH	Jamy		Sheet No.		3 from 3

Customer: