

# EDCON-COMPONENTS



## Description

Plug-in tab to solder tab or plug-in tab to plug in tab  
 4,8mm ( 0,19 in.) quick connect tab  
 Available in PA or PVC  
 Recommend mounting hardware: M3 pan head screw or similar sized sheet metal screw, self-tapping screw or rivet

## Dimensions (mm)

## Technical Data

Center to Center Spacing : 12mm (0,472 in.) Nominal Cross Section  
 4,8mm version for 2,5mm<sup>2</sup> (3874 mils)

## Material

**Version:** PVC  
**Molding:** plasticised PVC transparent color  
**Temperatur:**  
**Short Time** 80°C  
**Continious** 70°C  
**Comparative Tracking Index** CTI > 400

**Version:** PA  
**Molding:** polyamide, self extinguishing to UL94, V2 color off-white  
**Temperatur:**  
**Short Time** 140°C  
**Continious** RTI 105°C

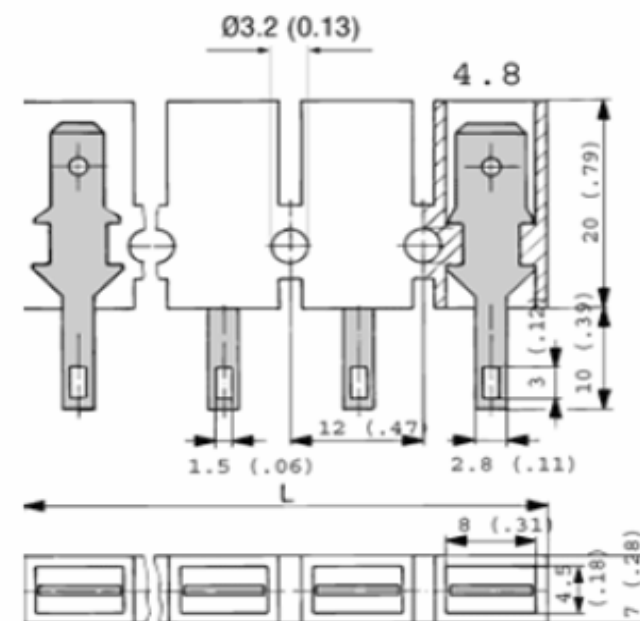

Length of Connector (L) L=No. of Poles x Center to Center Spacing - 2mm

## Terminal Options

Part No.: **N40007**

Customer:

DRW:	Jason	CHKD	Wilson	MATL:	Wilson	TOLERANCE	Mason	DATE	20.10.2011
APPD:	Schumi			FINISH	Jamy		Sheet No.		1 from 2

[www.edcon-components.com](http://www.edcon-components.com)

email: [info@edcon-components.com](mailto:info@edcon-components.com)

# EDCON-COMPONENTS



## Ordering Informations

Serie	No. Of Pos.	Material of Plastic	ROHS	Packing						
-------	-------------	---------------------	------	---------	--	--	--	--	--	--

<b>N40007</b>	-	<b>02</b>	<b>PV</b>	<b>R</b>	<b>BU</b>					
---------------	---	-----------	-----------	----------	-----------	--	--	--	--	--

<b>02-15 Pos.</b>	<b>PV= PVC</b>	<b>R= ROHS Conform</b>	<b>BU= Bulk-Ware</b>			
	<b>PA= PA</b>	<b>N= NON ROHS Conform</b>	<b>IV= Individual</b>			

Terminal Options
Part No.: <b>N40007</b>
Customer:

DRW:	Jason	CHKD	Wilson	MATL:	Wilson	TOLERANCE	Mason	DATE	20.10.2011
APPD:	Schumi			FINISH	Jamy		Sheet No.		3 from 3